



SERVICE BOOK

MOUNTING INSTRUCTION OF CONNECTORS

SERVICE MOUNTING INSTRUCTION ASPÖCK SYSTEMS SERVICE MOUNTING INSTRUCTION ASPÖCK SYSTEMS SERVICE MOUNTING INSTRUCTION ASPÖCK SYSTEMS



www.aspoeck.com

List of contents

		Page
Symbol legend		4
DC-System (double click)		10
P&R-System (press & ready)		12
Bayonet	2 pin	14
	5 pin	18
	8 pin	22
	15 pin	28
ASS1, ASS2	2 pin	32
ASS1, ASS2, ASS2.1	7 pin	36
ASS3	3 pin	40
	17 pin	44
AMP	4 pin	48
	7 pin	52
SuperSeal	2 pin	56
	3 pin	60
	4 pin	64
	6 pin	68
DEUTSCH connector	2 pin	72
	4 pin	76
	6 pin	80
Standard connector	8 pin	82
	12 pin	82
Caravan connector	16 pin	84
ISO 1185	7 pin	85
ISO 3731	7 pin	85
ISO 12098	13 pin	86
	15 pin	87
ISO 1724	7 pin	88
ISO 11446	8 pin	89
	13 pin	89
DIN 9680	3 pin	90
VBG	14 pin	91

Symbol					
	Masse	Earth	massa	Masse	Masa
	Blinker links	LH rear direction indicator	freccia sinistra	Clignotant gauche	Intermitente izquierdo
	Blinker rechts	RH rear direction indicator	freccia destra	Clignotant droit	Intermitente derecho
	Bremslicht	stop	stop	Feu stop	Luz de freno
	Standlicht links	LH Tail	posizione sinistra	Feu de position gauche	Luz posición izquierda
	Standlicht rechts	RH Tail	posizione destra	Feu de position droit	Luz posición derecha
	Nebelschlussleuchte	rear fog	retronebbia	Feu de brouillard	Luz antiniebla
	Rückfahrleuchte	reverse	retromarcia	Feu de recul	Luz marcha atrás
	All. Stromversorgung (+)	permanent power supply	positivo permanente	Alimentation électrique permanente (+)	corriente continua
	Achsanhhebung	axle lift	Sollevatore	Relevage d'essieu	dispositivo de elevación del eje
	Federspeicheranzeige	braking control	Controllo funzionamento freni	Contrôle freinage remorque	Control de frenos para trailers
	Verschleißanzeige	brake pad wear Indicator	Controllo usura pastiglie	Témoin d'usure des plaquettes de frein	Indicador de desgaste de las pastillas de freno
	Masse für Elektroniken	Earth - Data	Massa per elettronica	Masse des éléments électroniques	masa funciones electrónicas
	freie Wahl	unallocated	libero	Libre	Libre elección

					Symbol
Terra	Massa	Jord	jord	maa	
Pisca esquerdo	knipperlicht Links	Venstre blinklys	blinker vänster	vilkku vasen	
Pisca direito	knipperlicht Rechts	Høyre blinklys	blinker höger	vilkku oikea	
Freio	Rem licht	Bremselys	bromslyus	jarruvalo	
Luz de posição esquerda	Achterlamp Links	Venstre parklys	parklyus vänster	parkki vasen	
Luz de posição direita	Achterlamp Rechts	Høyre parklys	parklyus höger	parkki oikea	
Luz de neblina	Mist lamp	Tåkelys	dimlyus	sumuvalo	
Luz de Ré	Achteruitrij lamp	Baklys	backlyus	peruutusvalo	
corrente contínua	Constante stroomverzorging	Allmenn strømforsyning	allmän strömförsörjning	jatkuva virta	
dispositivo de elevação do eixo	Aslift	Akselløft	axellyft	akselinosto	
Controle de funcionamento dos freios	Remcilinder markering	Bremseindikator	bromsindikator	jousijarrun ilmaisin	
Indicador de desgaste de pastilhas de freio	Remslijtage indicator	Slitasjeindikator	slitageindikator	jarrujen kulumisen ilmaisin	
Terra para funções electrónicas	Massa Data	Jord for elektronikk	jord för elektronik	elektroniikan maa	
Livre	Vrije positie	Fritt valg	fritt val	vapaa	

Symbol legend

Symbol					
	Mass	Masa	Masa	маса	масса
	Vasak suunatuli	Kreisais pagrieziens	Lewy Kierunkowskaz	лівий поворотник	левый поворотник
	Parem suunatuli	Labais pagrieziens	Prawy Kierunkowskaz	правий поворотник	правый поворотник
	Pidurituli	Stop signāls	Światło Stop	стоп-сигнал	стоп-сигнал
	Vasak tagatuli	Kreisais gabarīts	Lewa Pozycja	ліве габаритне світло	левый габаритный свет
	Parem tagatuli	Labais gabarīts	Prawa Pozycja	праве габаритне світло	правый габаритный свет
	Udutuli	Miglas lukturis	Światło Przeciwmgłowe	проти́во- туманний лі́тар	проти́во-туманный фонарь
	Tagurdustuli	Atpakaļgaitas lukturis	Światło Cofania	лі́тар заднього ходу	фонарь заднего хода
	Pidev toide	Pastāvīgs spriegums	Stale Zasilanie	постійна напруга	постоянное напряжение питания
	Telje tōste	Paceļamais tiits	Podnoszenie Osi	підйомна вісь	подъёмная ось
	Pidurduskontroll	Bremžu kontrole	Kontrola Hamowania	керування гальмуванням	управление торможением
	Piduriklotside kulumise indikaator	Bremžu nodiluma sensors	Wskaźnik Zużycia Okładzin Hamulcowych	датчик зносу гальмівних колодок	датчик износа тормозных колодок
	Infokaabli mass	Masa- Dati	Masa Elektroniki	маса електроніки	масса электроники
	Vaba	Brīvais	Wolny	вільний	свободный

Symbol legend

					Symbol
Uzemnění	Uzemnenie	Földelés	masa, ozemljitev	Masa, uzemljenje	
Blinkr levá strana	Smerovka lavá strana	Index, bal	smerokaz levi	Lijevi žmigavac	
Blinkr pravá strana	Smerovka pravá strana	Index, jobb	smerokaz desni	Desni žmigavac	
Brzdové světlo	Brzdové svetlo	Féklámpa	stop luč	Štop svijetlo	
Parkovací světlo levé	Parkovacie svetlo lavé	Helyzetjelző, bal	leva pozicijska luč	Lijevo poziciono svijetlo	
Parkovací světlo pravé	Parkovacie svetlo pravé	Helyzetjelző, jobb	desna pozicijska luč	Desno poziciono svijetlo	
Mihovka	Hmlové svetlo	Ködlámpa	meglenka	Maglenka	
Zpáteční světlo	Svetlo spiatocky	Tolatólámpa	luč vzvratne vožnje	Rikverc svijetlo	
Stálý elektrický proud	Stály elektrický prúd	Töltés	napajanje	Napajanje	
Zdvihnutí nápravy	Zdvihnutie nápravy	Tengelyemelés	dvig osi	Podizač osovine	
Kontrola brzdy	Kontrola brzdy	Fékvisszajelző	kontrola zavor	Kontrola kočnica	
Indikátor opotřebení	Indikátor opotrebenia	Fékkopás jelző	indikator obrabe zavor	Indikator potrošnje kočnica	
Uzemnění elektroniky	Uzemnenie elektroniky	Elektr. Földelés	ozemljitev za elektroniko	Uzemljenje za elektroniku	
Volné	Volné	Szabad	odklijeno	Otključano	

Symbol				
	Masa, uzemljenje	Masa, uzemljenje	Masa (impamintare)	заземление
	Lijevi žmigavac	Levi žmigavac	indicator semnalizare stanga	ляв мигач
	Desni žmigavac	Desni žmigavac	indicator semnalizare dreapta	десен мигач
	Štop svijetlo	Štop svetlo	STOP	стоп сигнал
	Lijevo poziciono svijetlo	Levo poziciono svetlo	lampa pozitie stanga	габарит ляв
	Desno poziciono svijetlo	Desno poziciono svetlo	lampa pozitie dreapta	габарит десен
	Maglenka	Maglenka	lampa ceata	светлина задна за мъгла
	Rikverc svijetlo	Rikverc svetlo	lampa marsarier	светлини задна скорост
	Napajanje	Napajanje	Alimentare electrica permanenta	постоянно напряжение
	Podizač osovine	Podizač osovine	axa liftanta	повдигане оси
	Kontrola kočnica	Kontrola kočnica	control sistem franare	ръчна спирачка
	Indikator potrošnje kočnica	Indikator potrošnje kočnica	Indicator uzura placate frana	износване на накладките
	Uzemljenje za elektroniku	Uzemljenje za elektroniku	Masa	електроника заземление
	Otključano	Otključano	Liber	свободно

Symbol					Symbol
Şase, toprak	ترا	يضرال	הקראה		
Sinyal, sol	پچ اینهار	ماجتال یفلخلا رشؤملا نیمیلا	לאמש תותיא		
Sinyal, sağ	تسار اینهار	ماجتال یفلخلا رشؤملا راسیلا	ימי תותיא		
Fren	زمرت غارچ	فقتوت	סלב רוא		
Park, sol	پچ فقتوت غارچ	راسیلا لیڈلا عوض	לאמש הינח		
Park, sağ	تسار فقتوت غارچ	نیمیلا لیڈلا عوض	ימי הינח		
Arka sis	بیق نکش هم غارچ	یفلخلا بابضلا لیزم	לפרע רוא		
Geri vites	بیق مدند غارچ	فخللا یلا ریسمللا تراشا	סרוור/רוחאל העיסנ רוא		
Sürekli enerji	یمیاد هیذغت عبینم	٢٤سائک - میاد قاطلا تادادم	העובק הנחה		
Dingil kaldırma	روحم ربالاب	روحمللا عفر	ורס תמרה יוויח		
Treyler EBS	زمرت لرتنک	فوقولاب مکحشلا تراشا	הינח סלב יוויח		
Balata aşınma	تنل شیسارگنانشن	حبالوللا هیجالص امتنلا تراشا	הדיפר יאלב יוויח		
Şase, elektronik	لکینورتکللا یارب ترا	یضرال تانایب	הקינורטקלא הקראה		
Serbest hat	دازآ باسختنا	مرح/طبرلا مدع ؤلاح	יונפ		

DC System

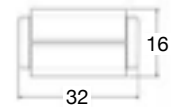

I_{max}=5A

IP69K

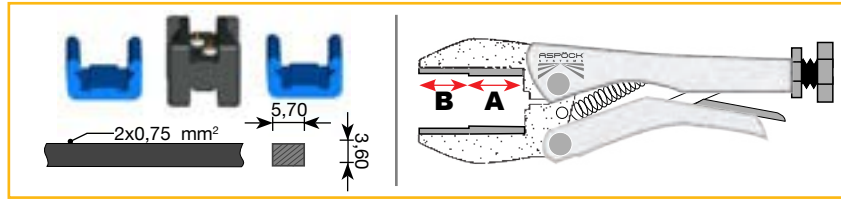

1.



2.



3.

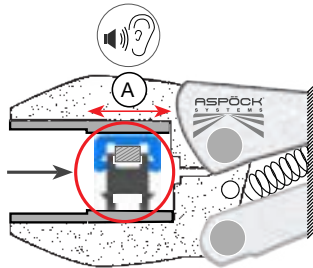

4.

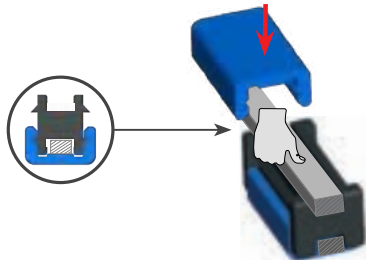

5.

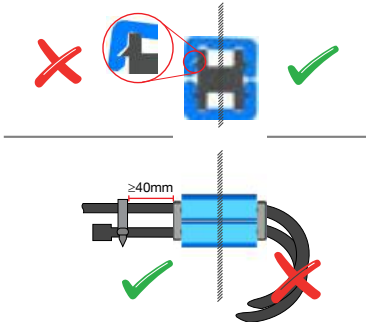
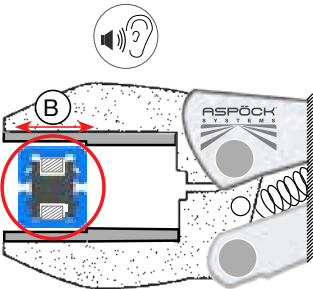

DC System

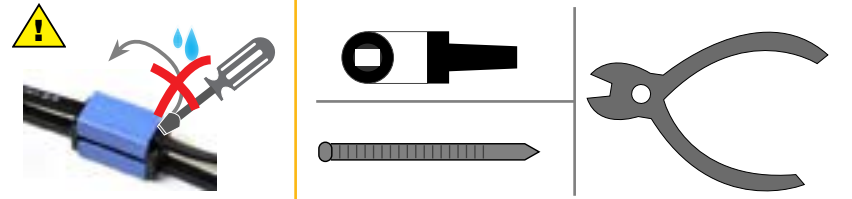

1.

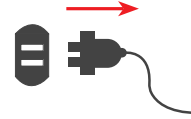

2.

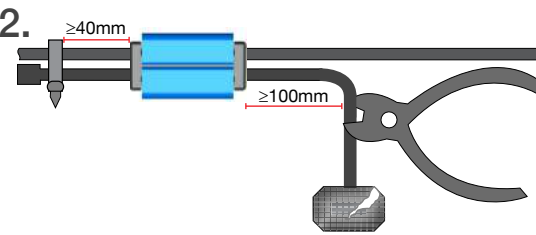

3.

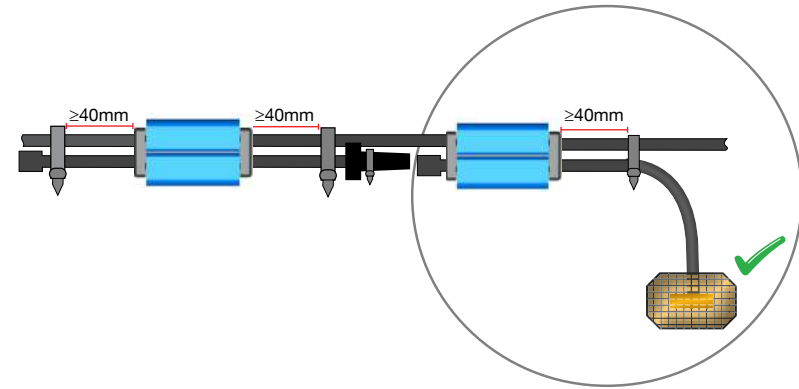
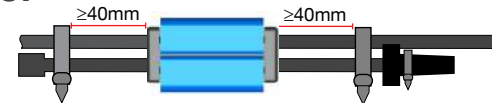

Watch the mounting video online!



P&R System

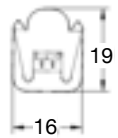
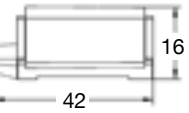

Imax=8A

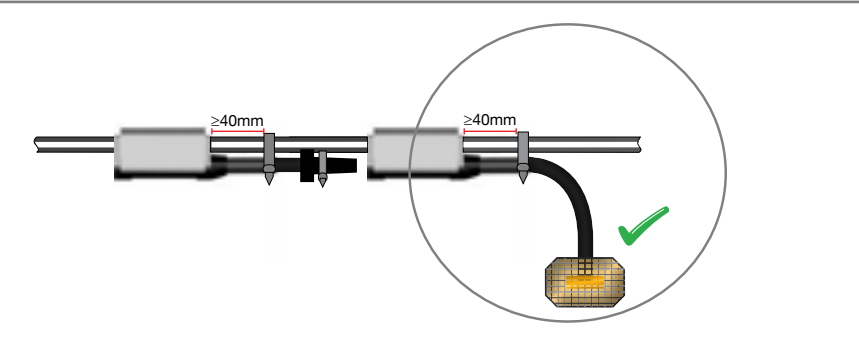
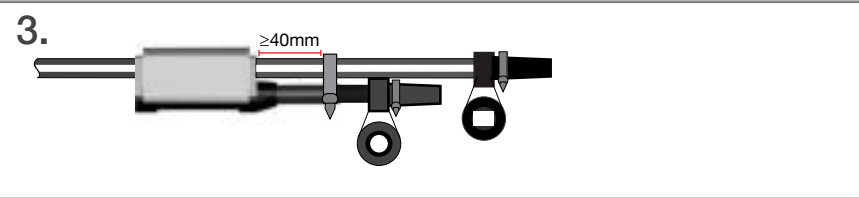
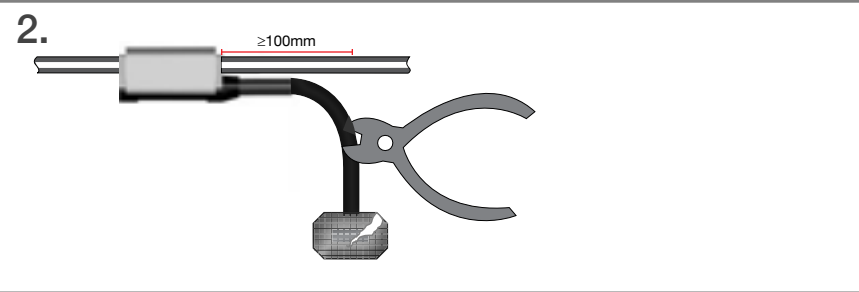
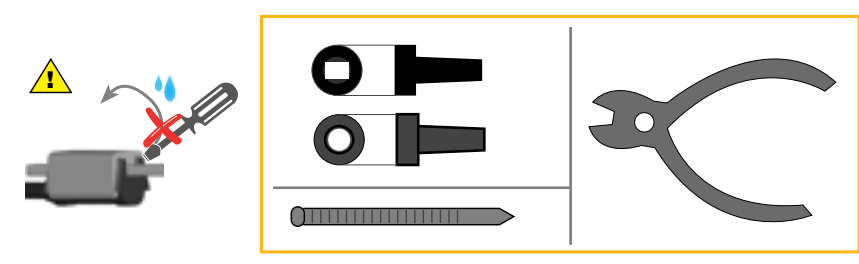
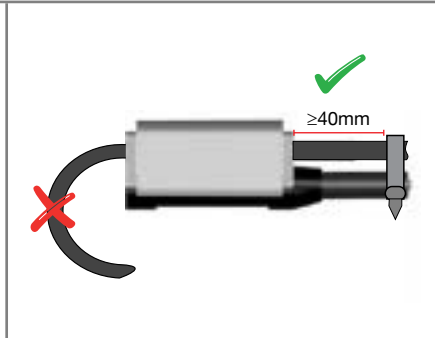
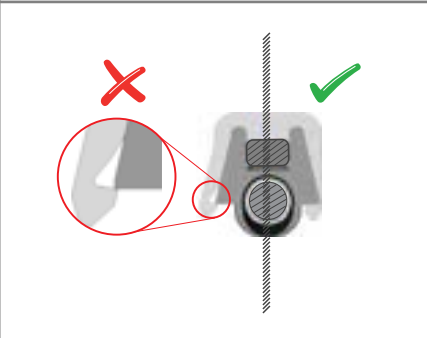
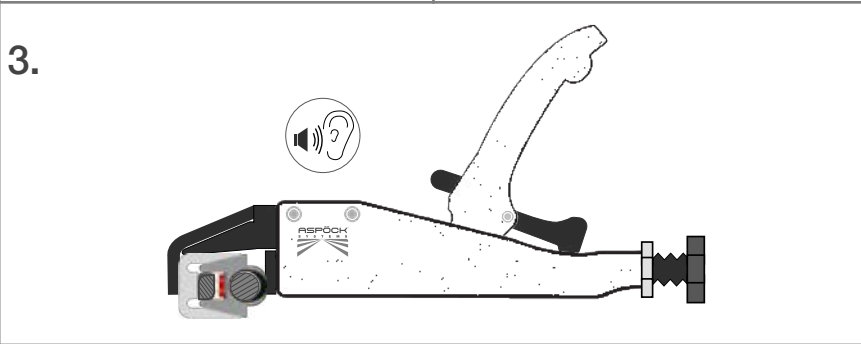
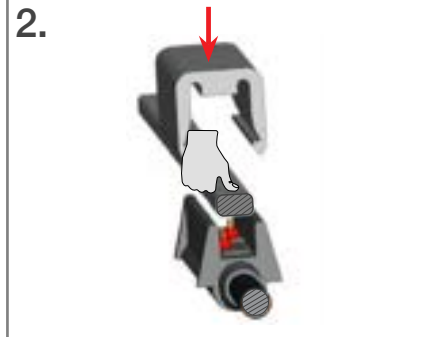
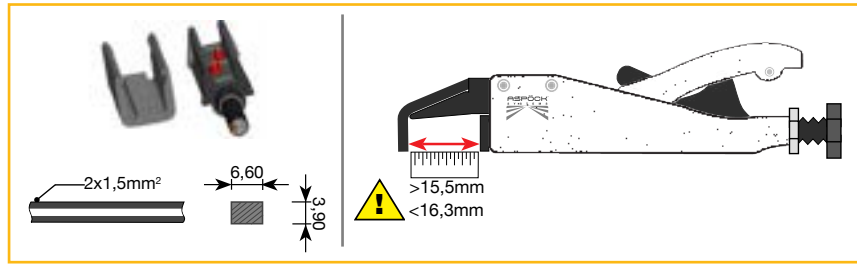

P&R System

Watch the repair video online!

Watch the mounting video online!

Bayonet
2 pin



SPARE PART NO.: 13-0246-004

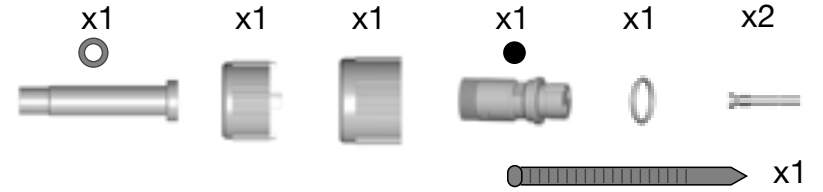

Bayonet
2 pin

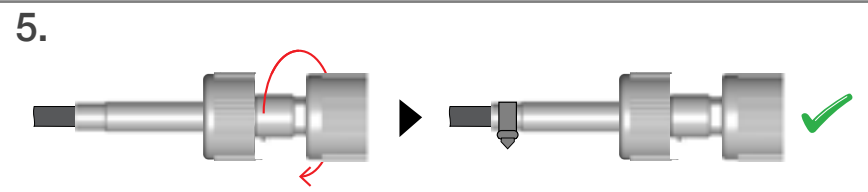
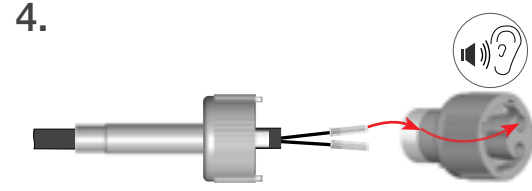
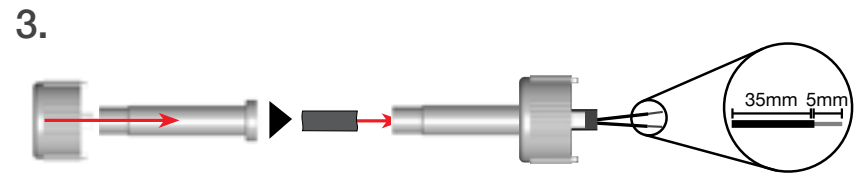
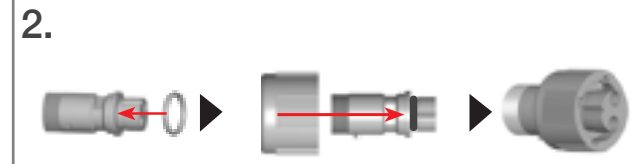
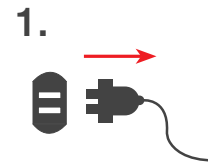
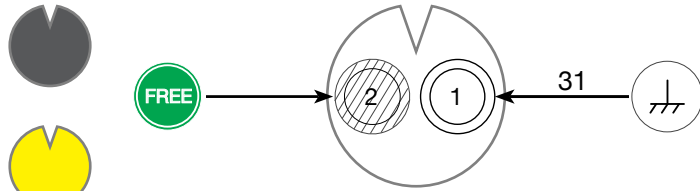

Imax=16A



Imax=16A



Bayonet
2 pin

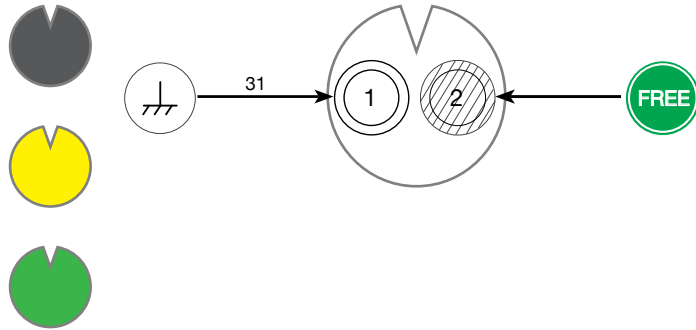

Imax=16A



Bayonet
2 pin



Imax=16A



SPARE PART NO.: 13-0236-004

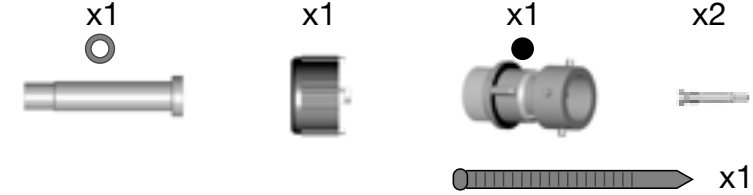

- 1.
- 2.
- 3.
- 4.
- 5.

Bayonet 5 pin

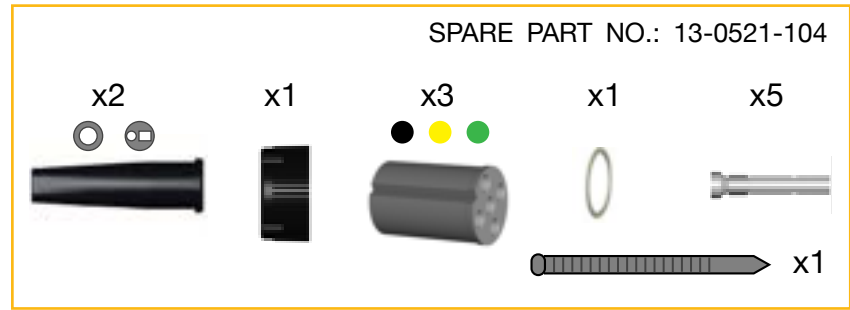

Bayonet 5 pin

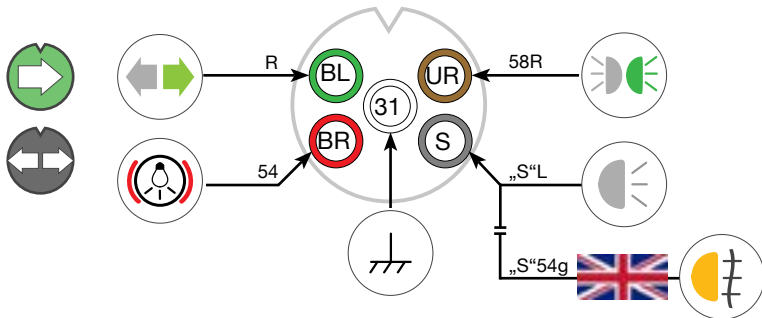
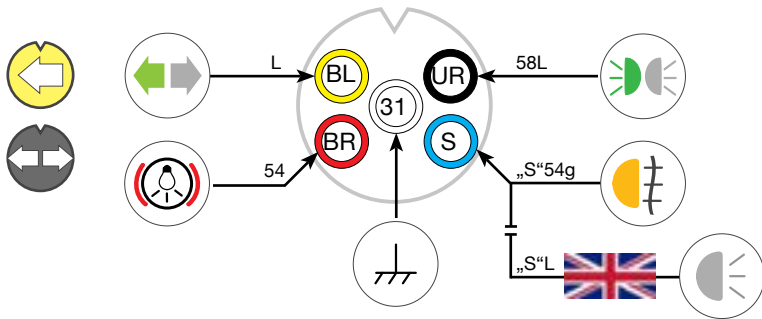

1. Plug the connector into the power source.
2. Insert the O-ring into the connector housing.
3. Insert the O-ring into the connector housing.
4. Insert the O-ring into the connector housing. A callout shows a 30mm diameter and 5mm depth for the O-ring groove.
5. Insert the O-ring into the connector housing. A callout shows the O-ring being pushed into the housing.

Imax=16A



Imax=16A



Bayonet 5 pin

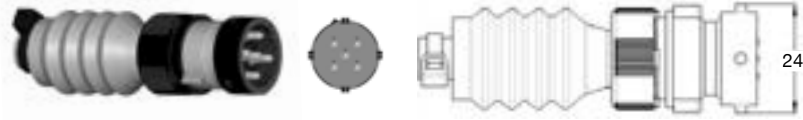

SPARE PART NO.: 13-0536-044

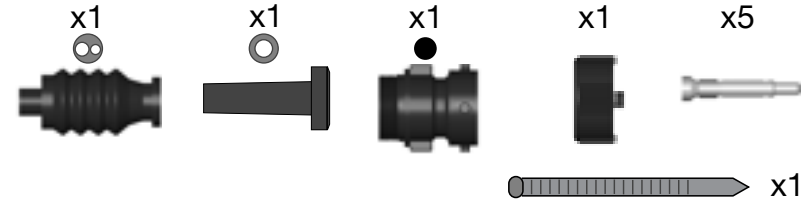

Bayonet 5 pin

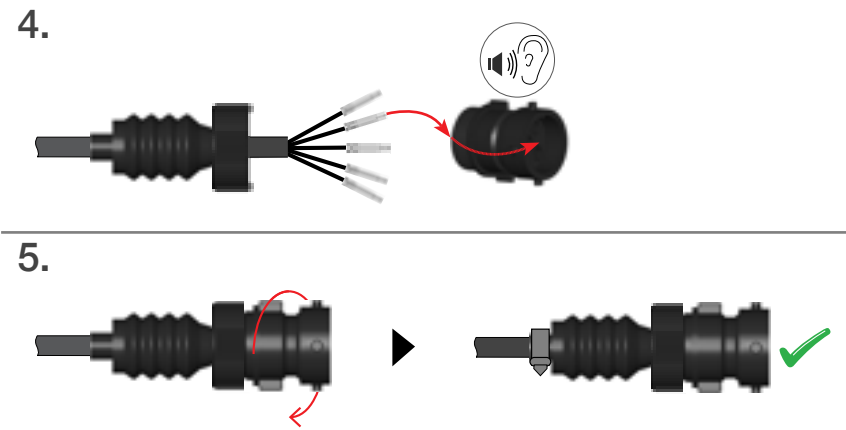
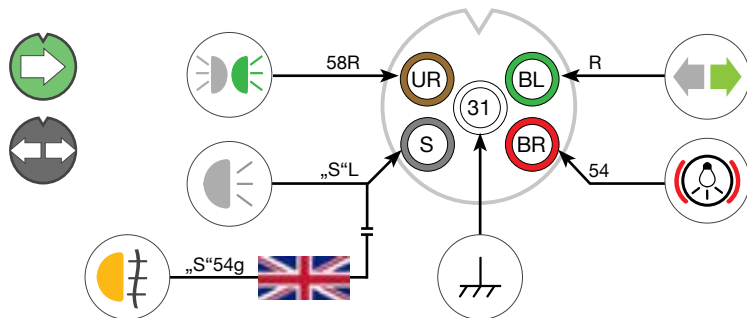
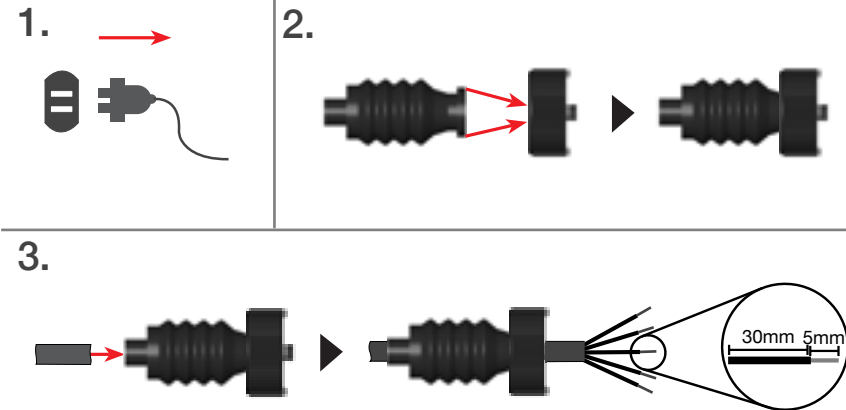
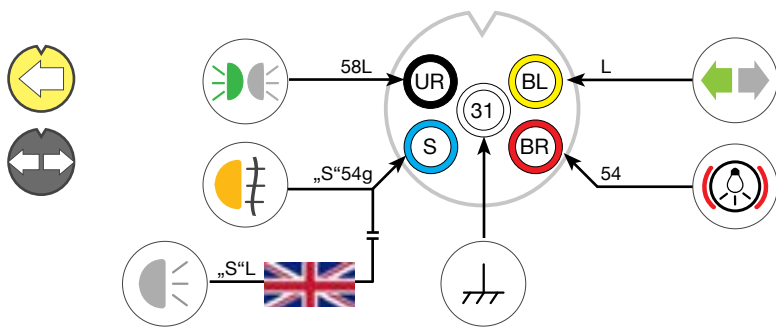

Imax=16A



Imax=16A



Bayonet
8 pin



SPARE PART NO.: 13-0828-034

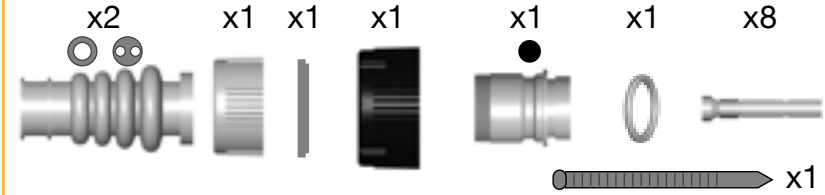

Bayonet
8 pin

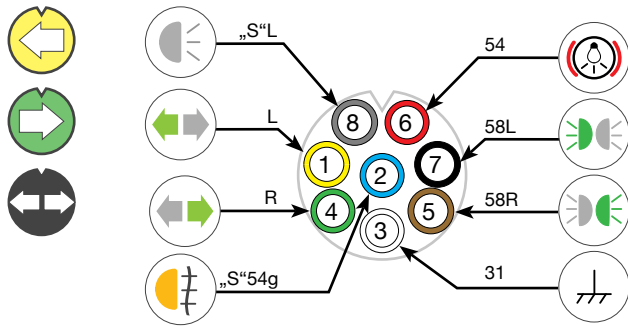

1. Insert the cable into the connector housing.
2. Insert the mounting sleeve into the connector housing.
3. Insert the mounting ring into the connector housing.
4. Insert the mounting nut into the connector housing.
5. Insert the mounting cap into the connector housing. The cap should be inserted to a depth of 30mm and 5mm.
6. Tighten the mounting screw. The screw should be tightened until it is flush with the housing. A green checkmark indicates that the assembly is complete.

I_{max}=16A

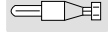

I_{max}=16A



Bayonet 8 pin



SPARE PART NO.: 15-0821-524

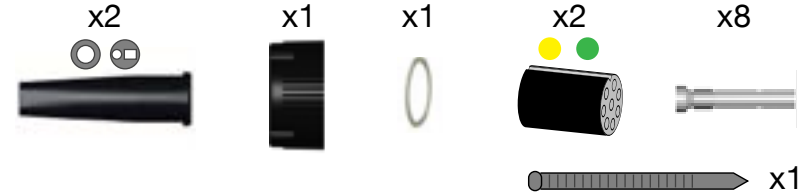

Bayonet 8 pin

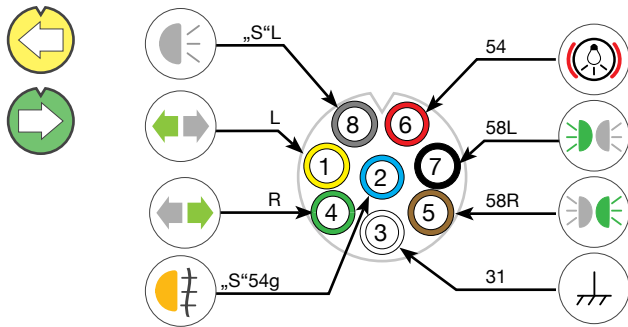
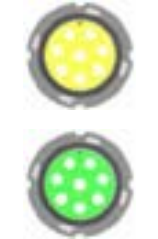

- 1.
- 2.
- 3.
- 4.
- 5.

I_{max}=16A



I_{max}=16A



Bayonet
8 pin

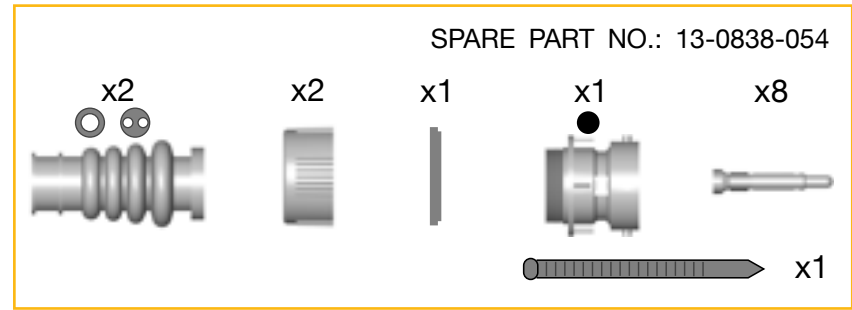

Bayonet
8 pin

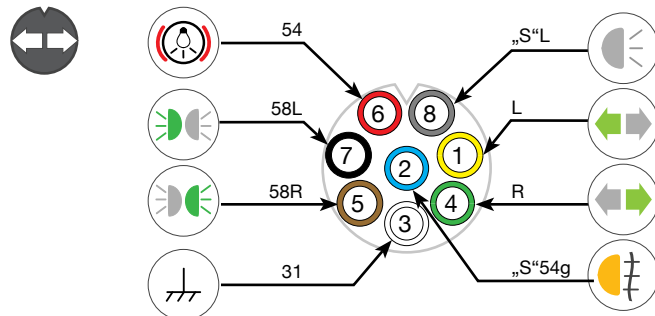

Imax=16A



- 1.
- 2.
- 3.
- 4.
- 5.

Imax=16A



Bayonet
15 pin

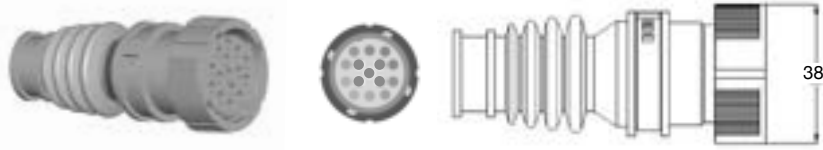

SPARE PART NO.: 13-1540-004

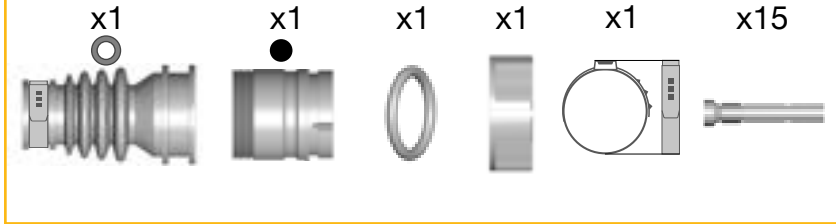

Bayonet
15 pin

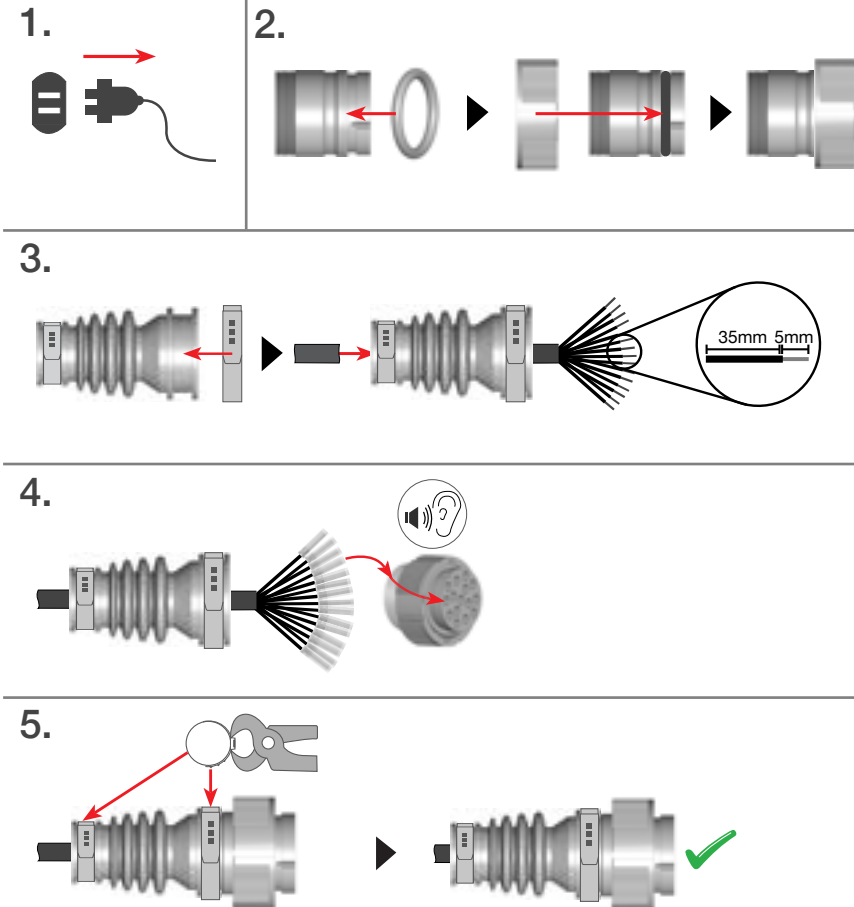
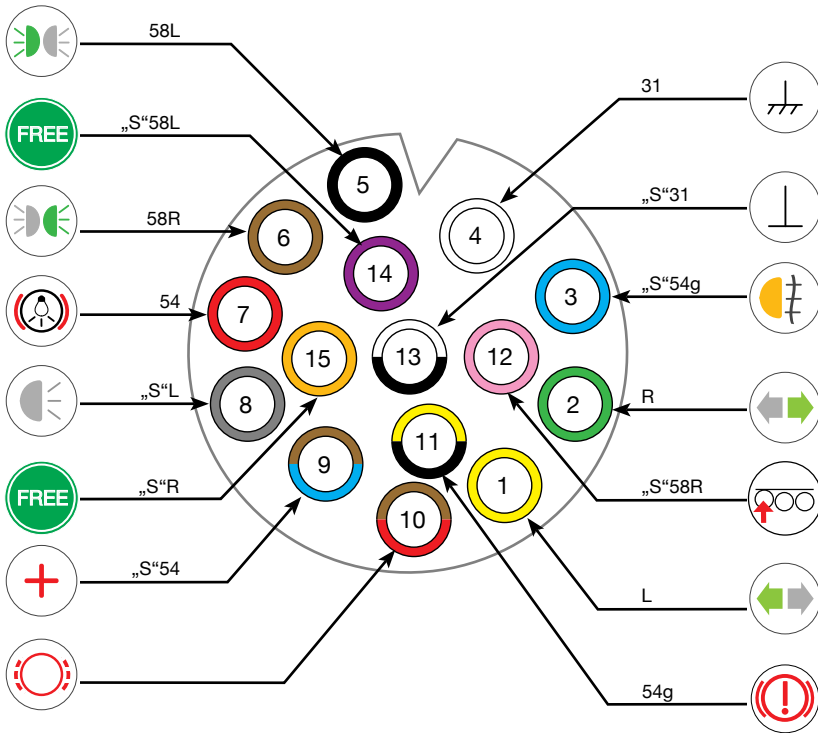

Imax=16A



Imax=16A



Bayonet 15 pin



SPARE PART NO.: 13-1530-004

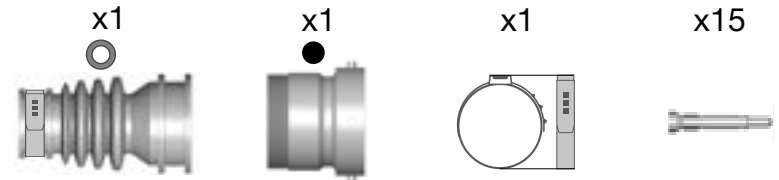

Bayonet 15 pin

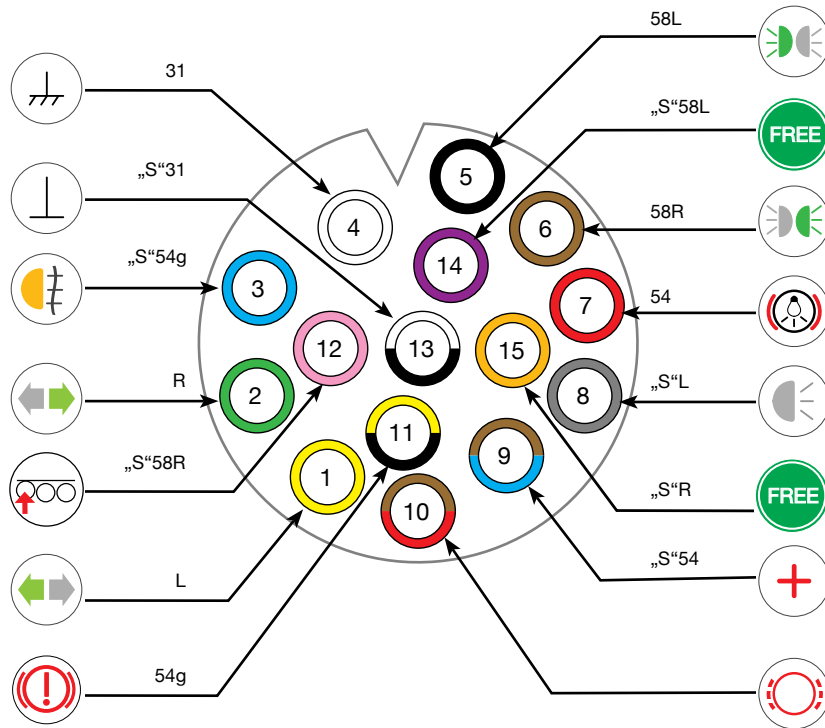

1. Plug the connector into the mating socket.
2. Push the connector into the socket until it is fully seated.
3. Tighten the nut on the connector. A callout shows a 35mm diameter and 5mm height for the nut.
4. Tighten the contact ring on the connector. A callout shows the ring being pushed onto the pins.
5. Tighten the O-ring on the connector. A callout shows the O-ring being pushed onto the connector.

Imax=16A



Imax=16A



ASS1,
ASS2
2 pin



Imax=25A

ASS 1

ASS 2

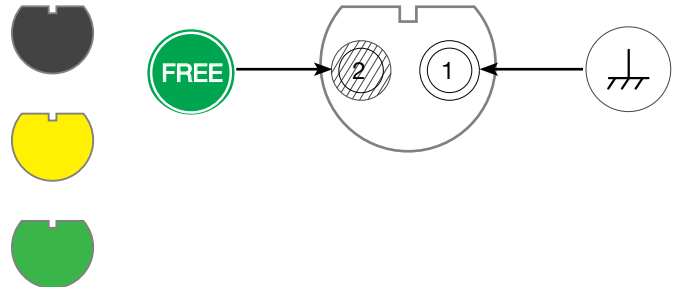
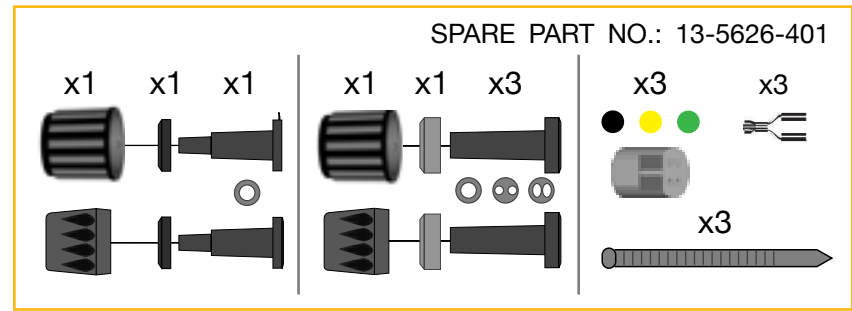

- 1.
- 2.
- 3.
- 4.
- 5.

ASS1,
ASS2
2 pin



Imax=25A



ASS1,
ASS2
2 pin

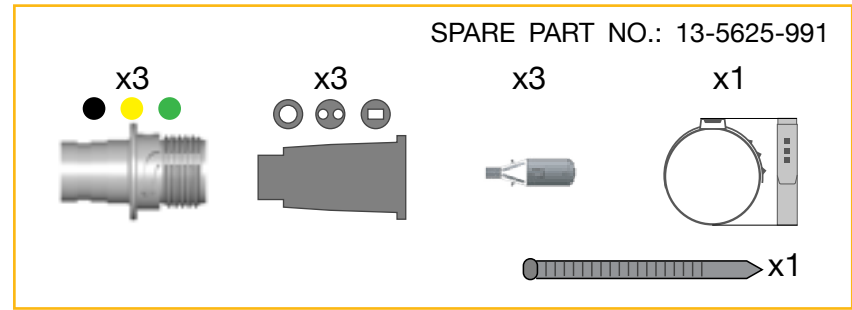

ASS1,
ASS2
2 pin

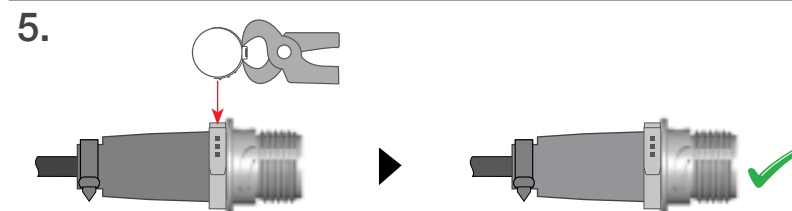
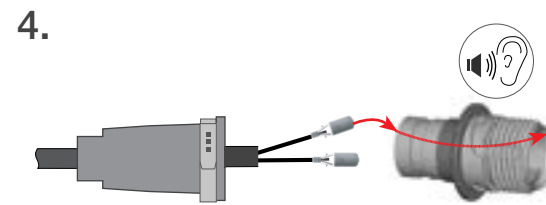
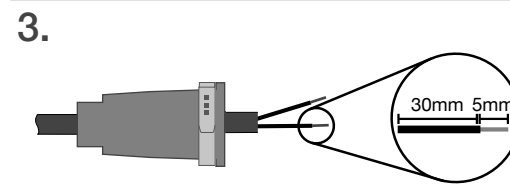
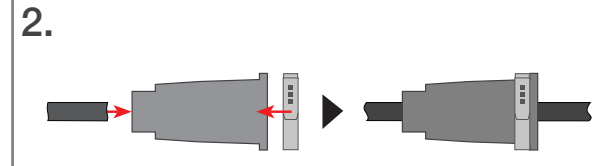
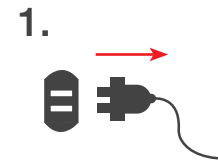
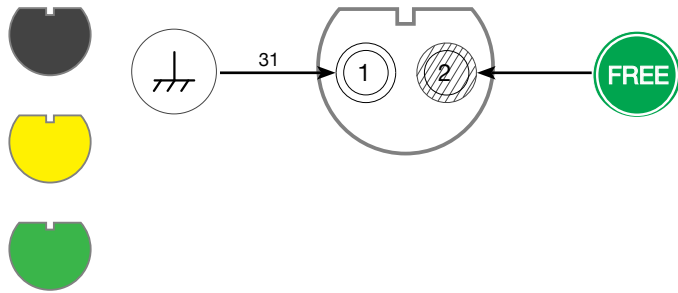

Imax=25A

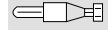

ASS 1

ASS 2



IP68

IP6K9K

Imax=25A

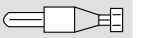

IP68

ASS1,
ASS2,
ASS2.1,
7 pin



Imax=25A

ASS 1 ASS 2,2.1

ADR-Zone 2 approved IP68

ADR-Zone 2 approved IP6K9K

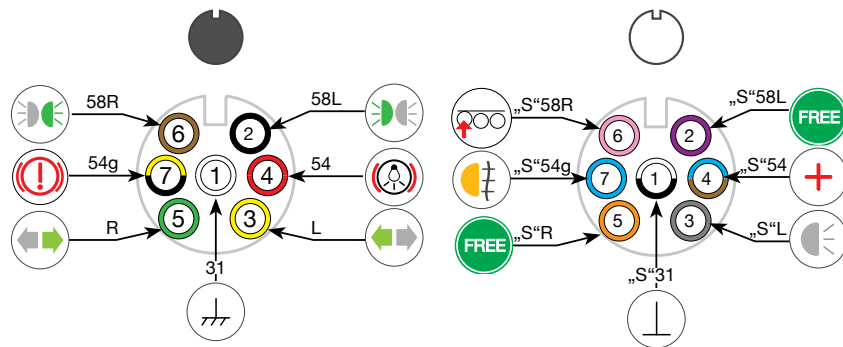
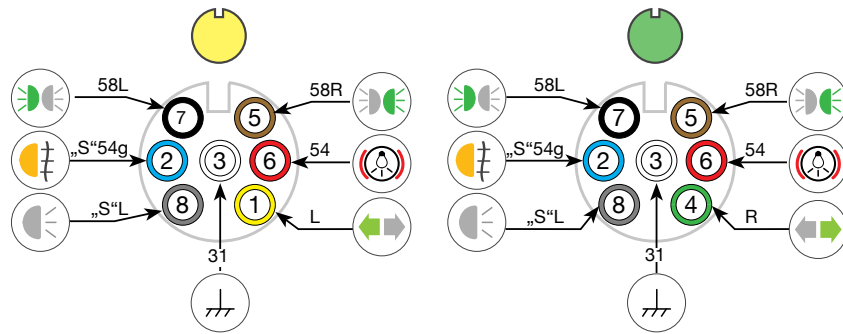

ASS1,
ASS2,
ASS2.1,
7 pin



Imax=25A

ADR-Zone 2 approved IP68

ASS 2 ASS 1 SPARE PART NO.: 13-5626-631

x1 x1 x1

x1 x1 x4 x9 x9

1.

2.

3.

4.

5.

ASS1,
ASS2,
ASS2.1,
7 pin

ASS1,
ASS2,
ASS2.1,
7 pin



SPARE PART NO.: 13-5625-981

x4 (black, white, yellow, green dots)
x1 (grey connector)
x9 (small grey pins)
x9 (array of pins)
x2 (circular lens)

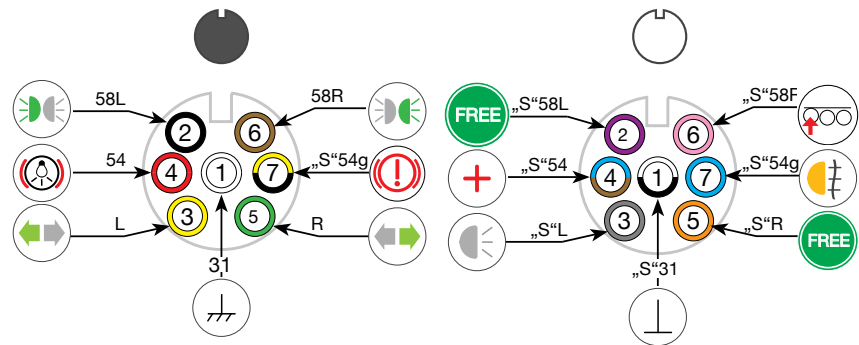
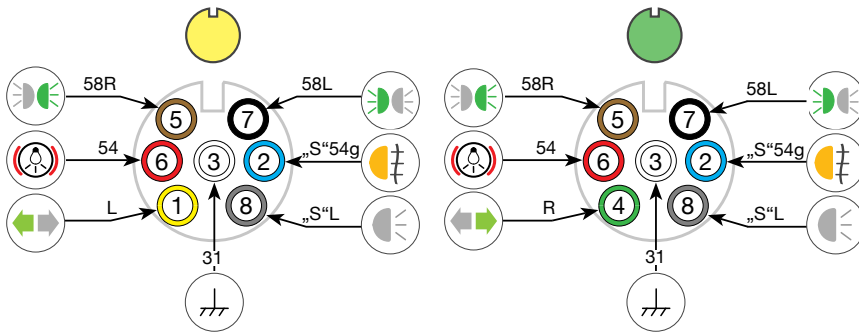

1. Plug the cable into the connector.
2. Insert the pins into the connector housing.
3. Push the pins into the housing until they are fully seated.
4. Trim the wires to a length of 30mm with a 5mm allowance.
5. Use pliers to crimp the wires onto the pins.

Imax=25A

Imax=25A

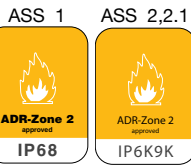

ASS3
3 pin



SPARE PART NO.: 13-0322-281

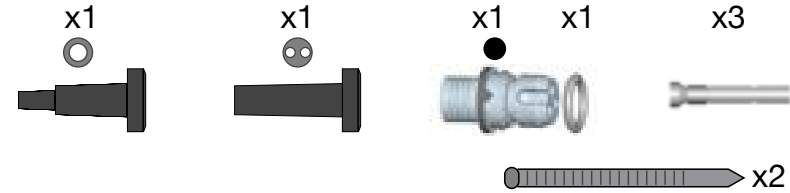

ASS3
3 pin

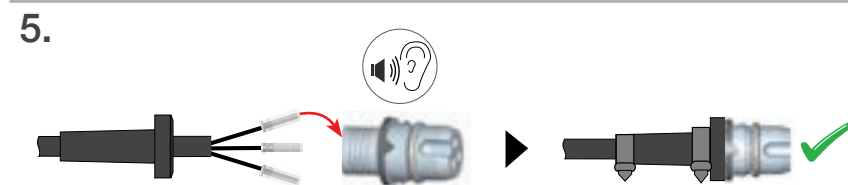
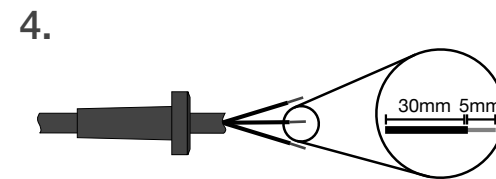
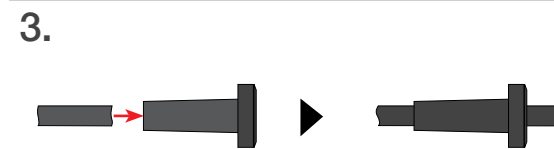
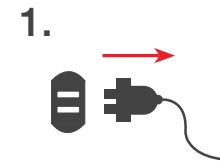
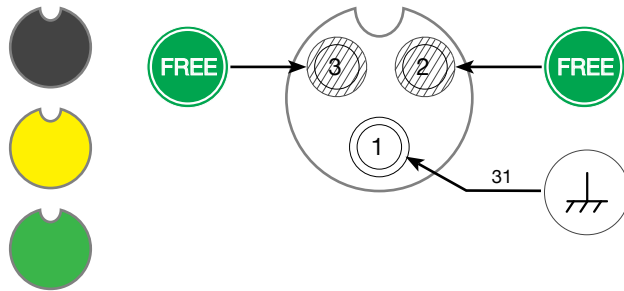

Imax=16A

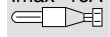

Imax=16A

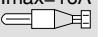

ASS3
3 pin

ASS3
3 pin

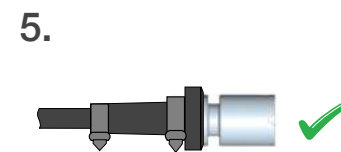
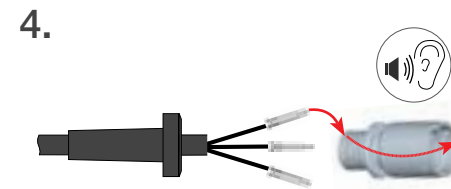
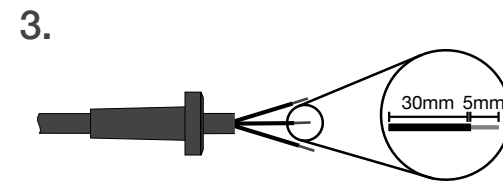
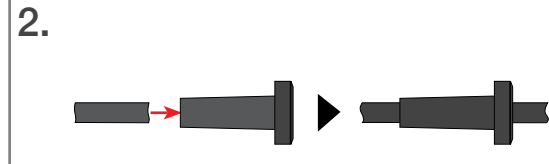
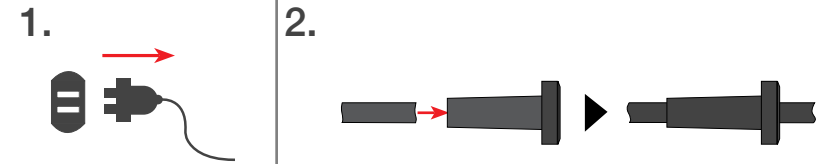
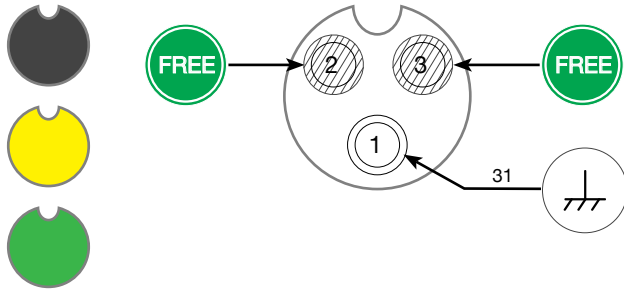
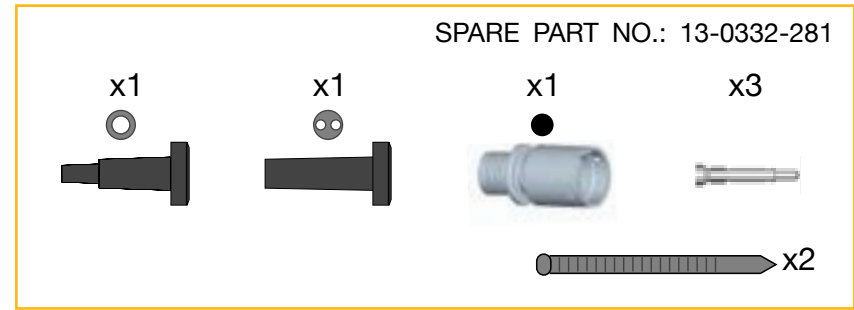

I_{max}=16A



I_{max}=16A

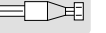

ASS3 17 pin female

Mounting instruction ASS3 17 pin female

ASS3
17 pin

ASS3
17 pin

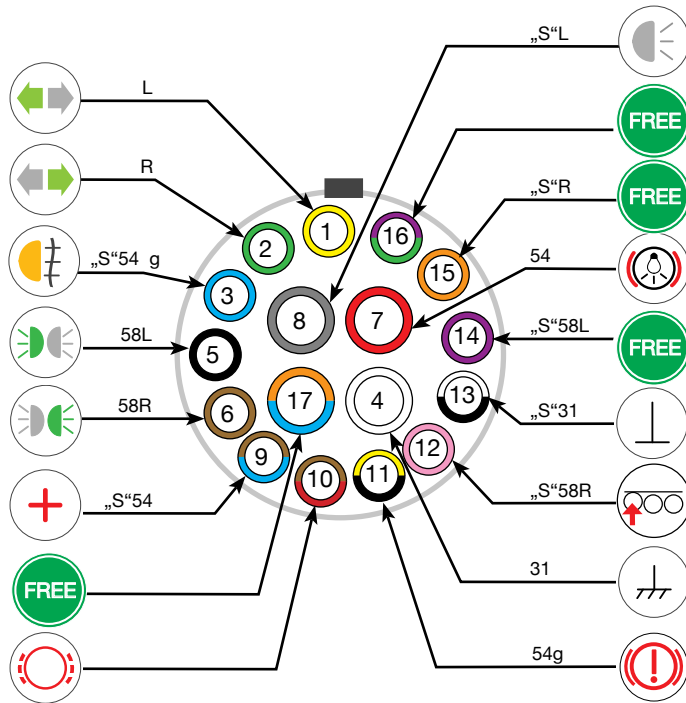
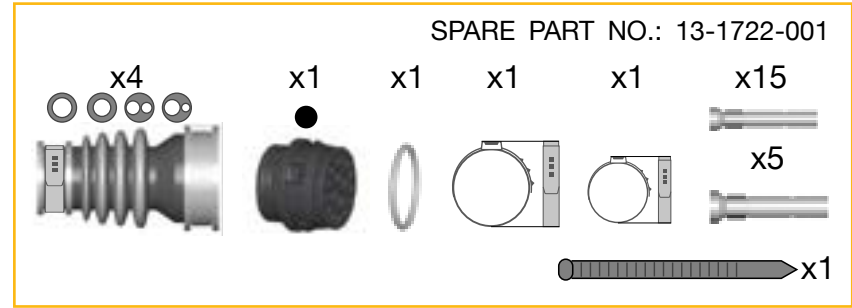

-
-
-
-
-

Imax=16A



Imax=16A

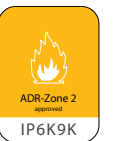

ASS3 17 pin male

ASS3
17 pin

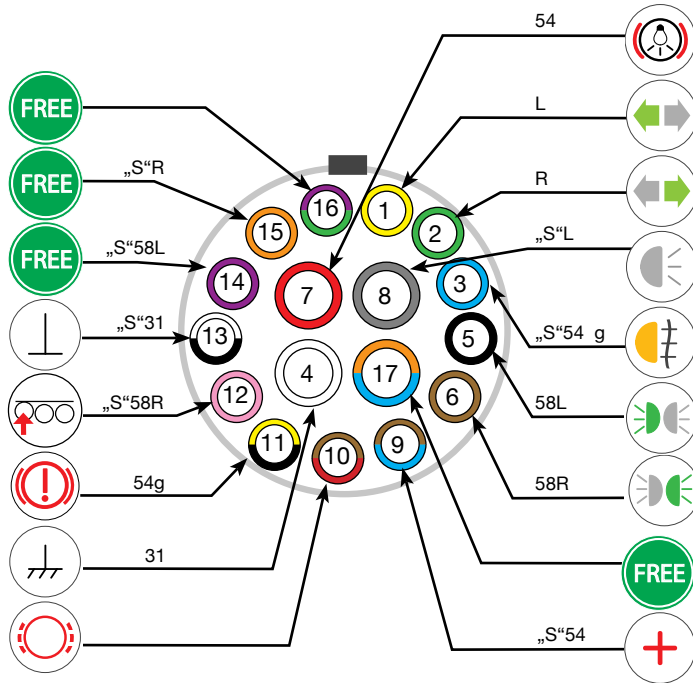

Imax=16A



Mounting instruction ASS3 17 pin male

ASS3
17 pin

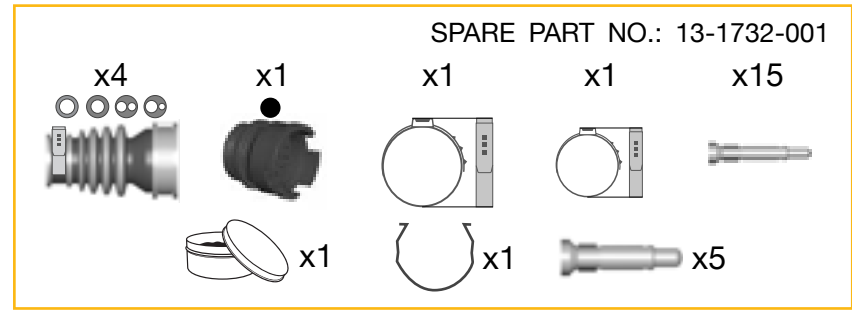

-
-
-
-
-

Imax=16A



AMP
4 pin



SPARE PART NO.: 15-7002-004

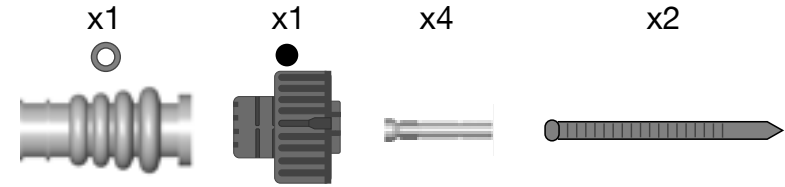

AMP
4 pin

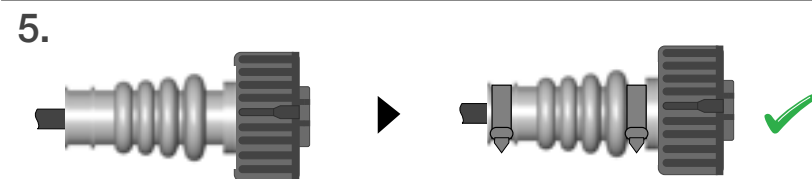
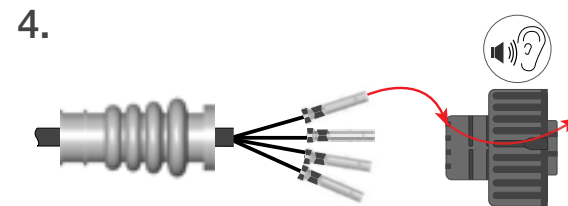
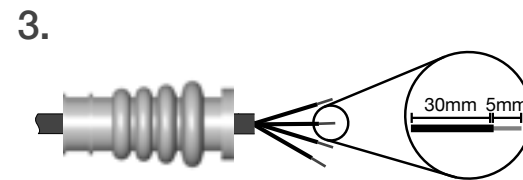
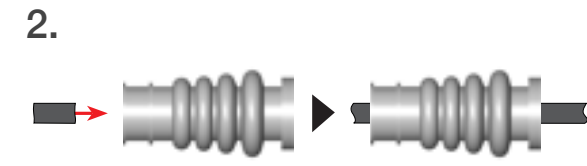
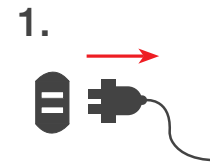
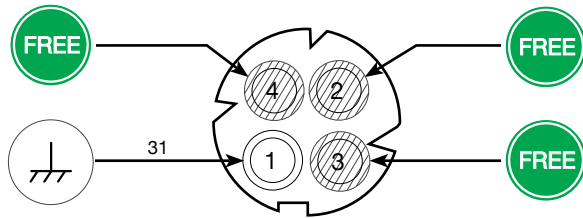

I_{max}=40A



I_{max}=40A

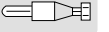

AMP
4 pin

AMP
4 pin

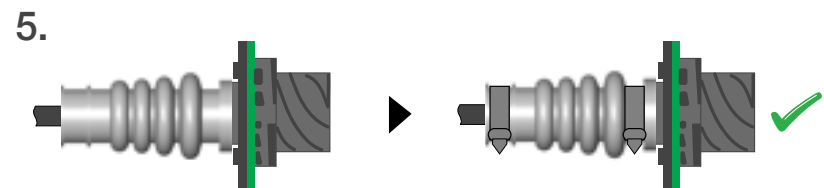
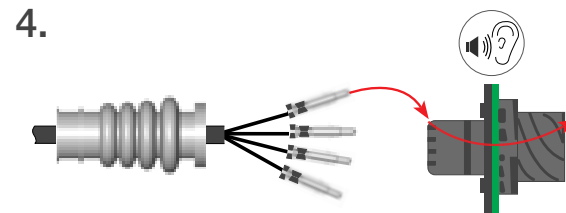
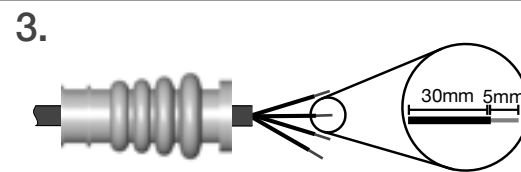
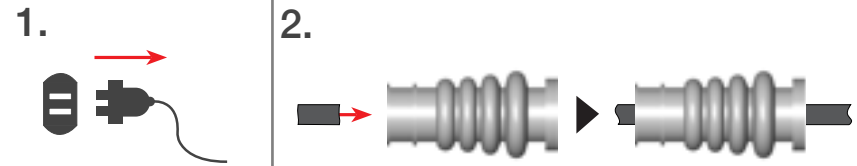
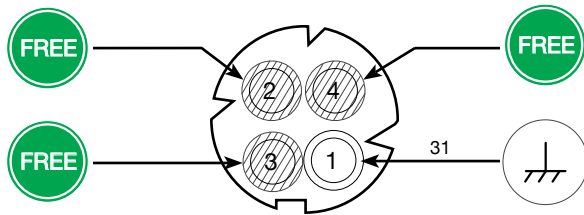
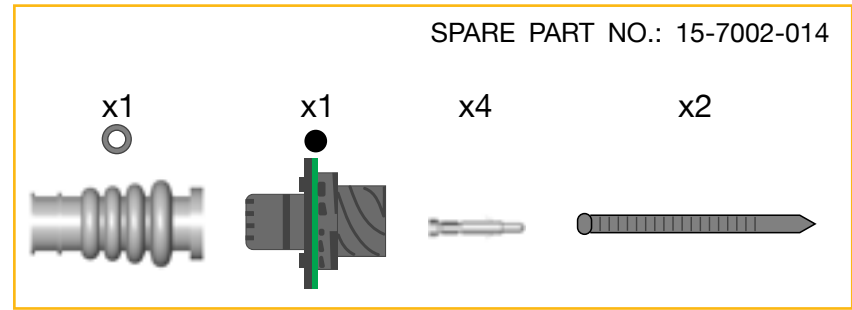

I_{max}=40A



I_{max}=40A



AMP 7 pin female

Mounting instruction AMP 7 pin female

AMP
7 pin

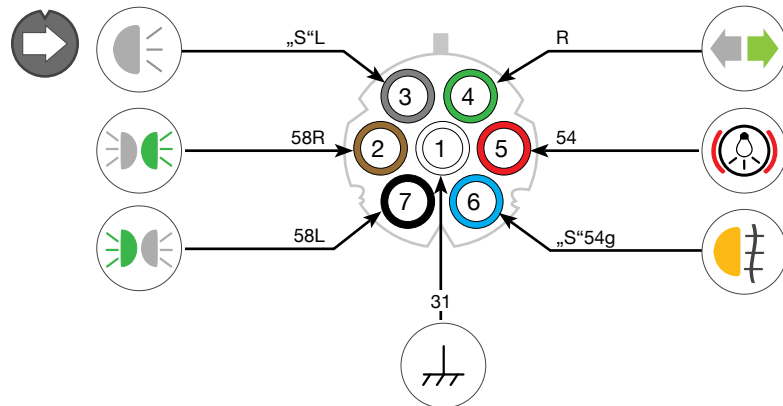
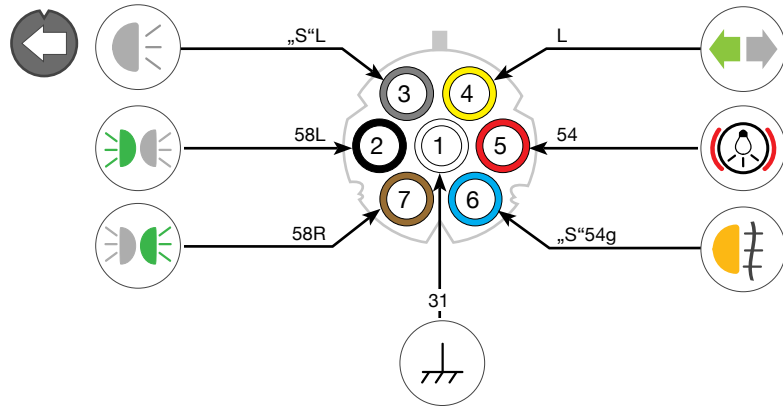

I_{max}=30A



AMP
7 pin

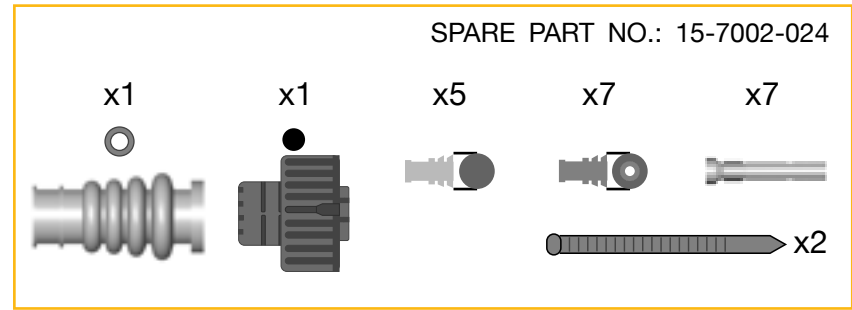

1. Insert the contact pins into the housing.
2. Push the housing onto the contact pins.
3. Trim the wires to a length of 30mm and 5mm.
4. Connect the wires to the contact pins.
5. Final assembly check.

I_{max}=30A

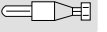

AMP
7 pin

AMP
7 pin

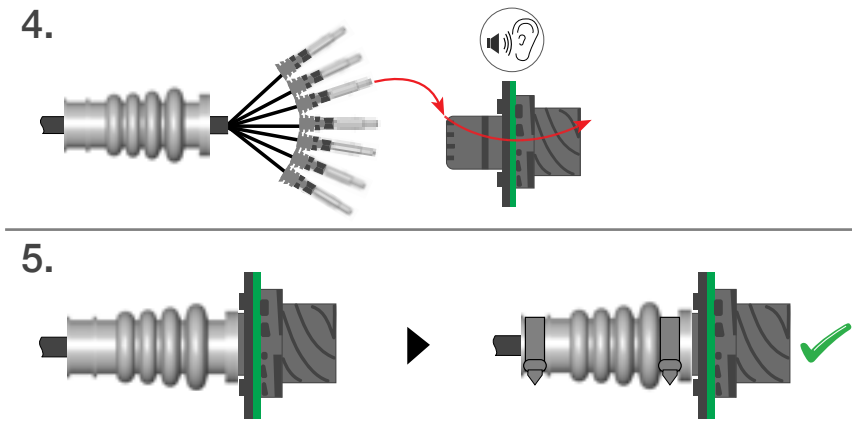
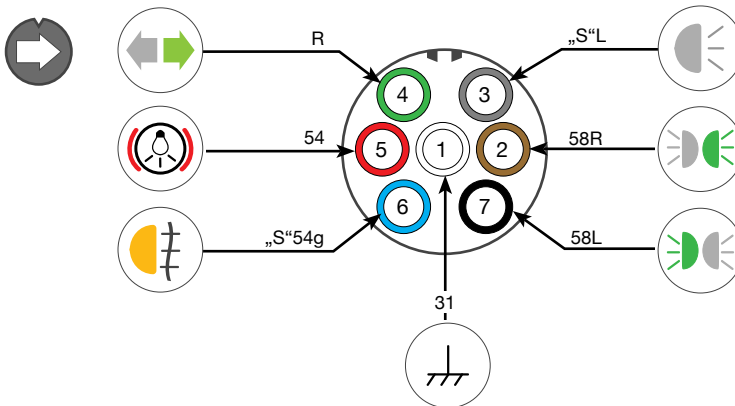
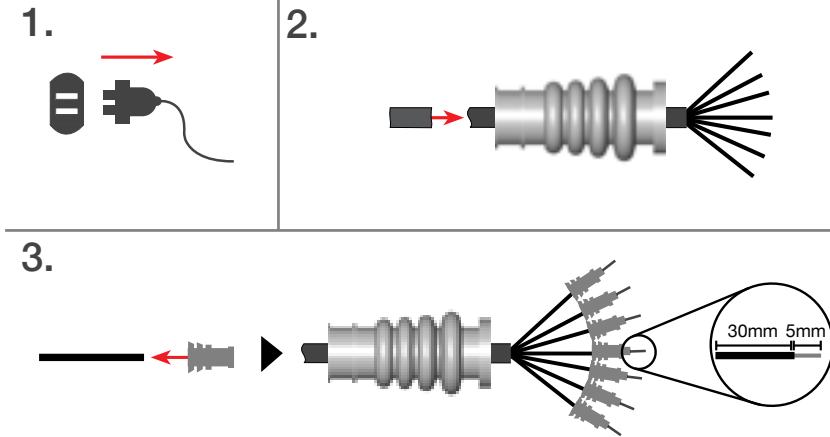
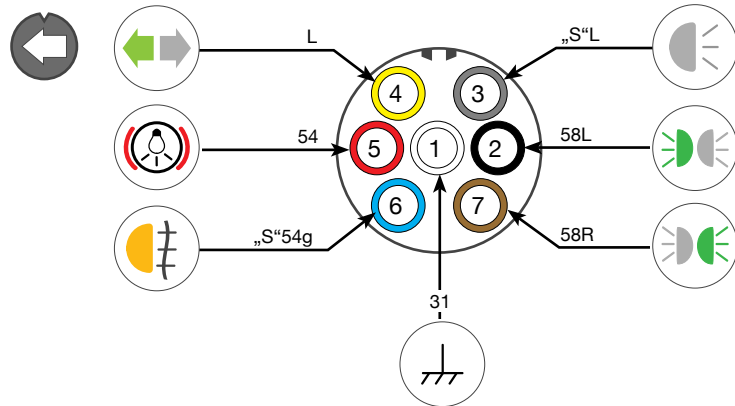
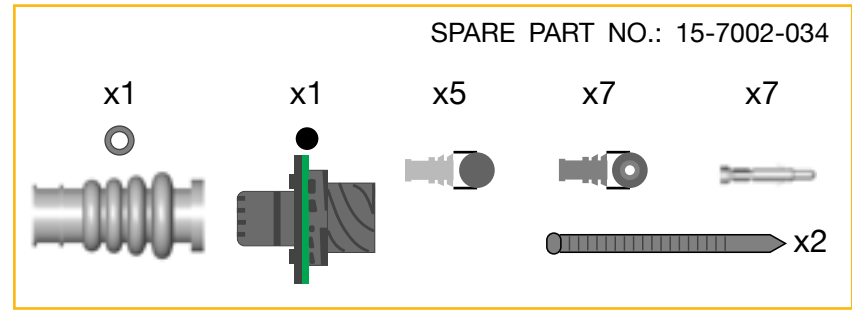

Imax=30A



Imax=30A



SuperSeal
2 pin

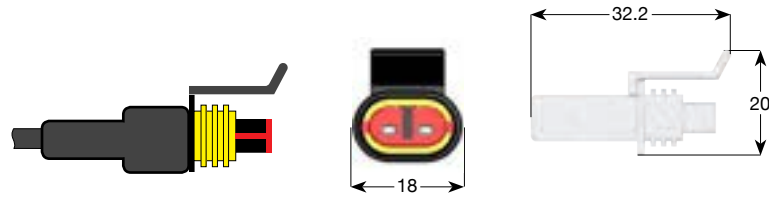

SPARE PART NO.: 15-7002-044

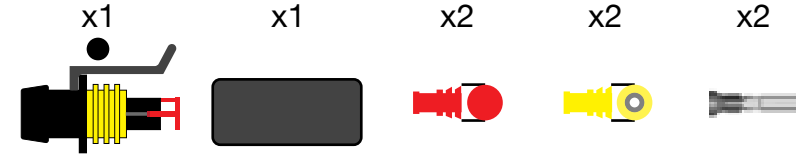

SuperSeal
2 pin

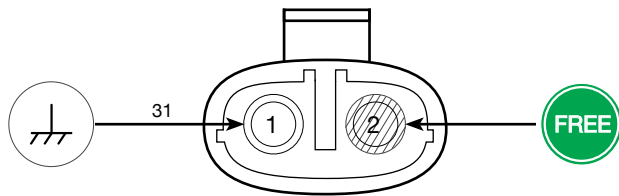

1.

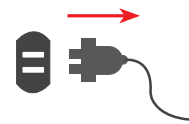

2.



3.

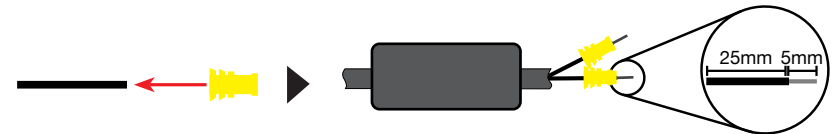

4.

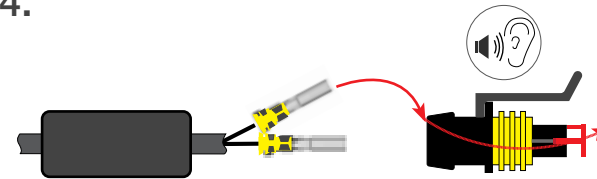

5.

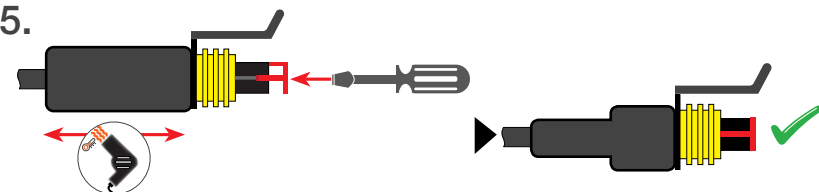

Imax=14A



Imax=14A



SuperSeal
2 pin



SPARE PART NO.: 15-7002-054

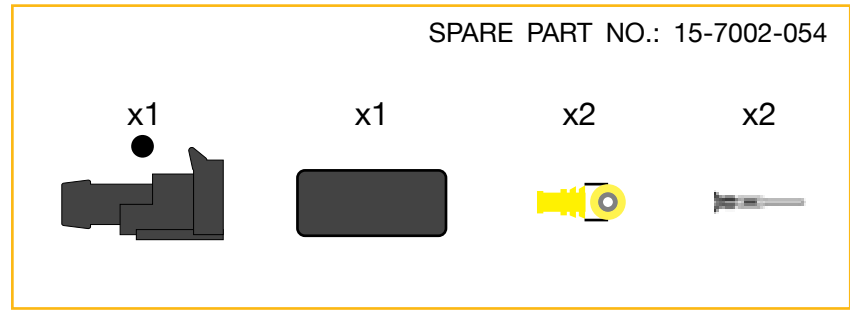

SuperSeal
2 pin

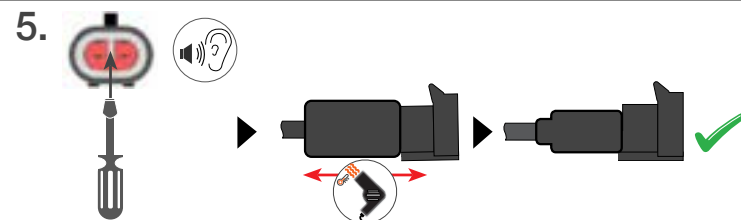
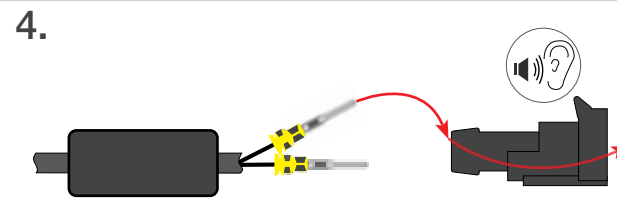
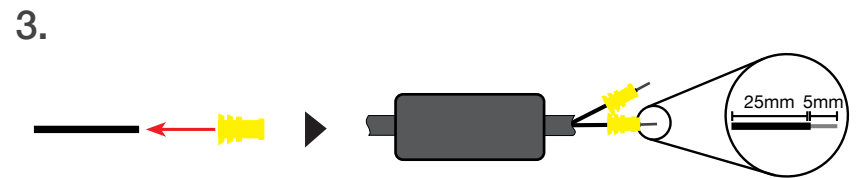
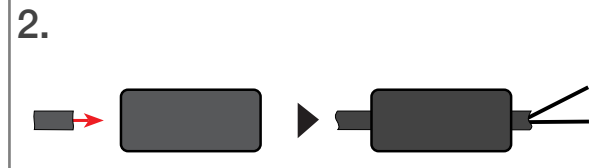
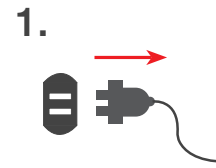
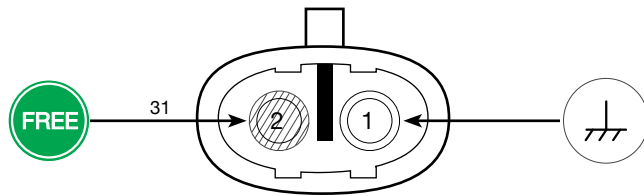

Imax=14A



Imax=14A

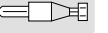

SuperSeal
3 pin

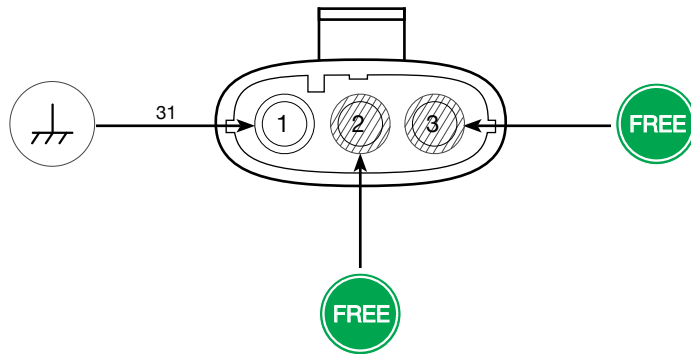
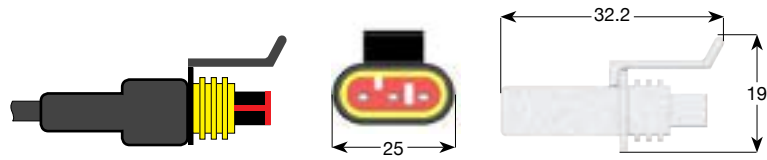

I_{max}=14A



SuperSeal
3 pin



SPARE PART NO.: 15-7002-064

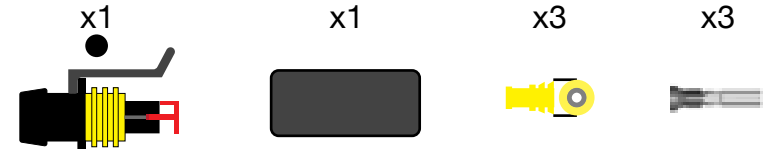

- 1.
- 2.
3.
30mm 5mm
4.
CLICK
- 5.

I_{max}=14A

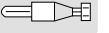

SuperSeal
3 pin

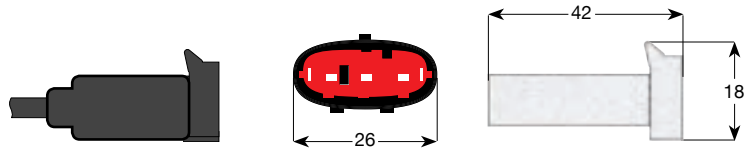

SPARE PART NO.: 15-7002-074

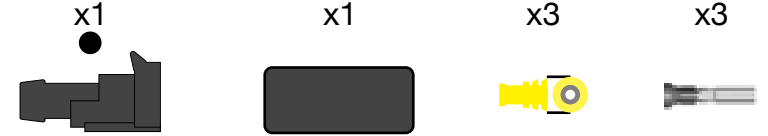

SuperSeal
3 pin

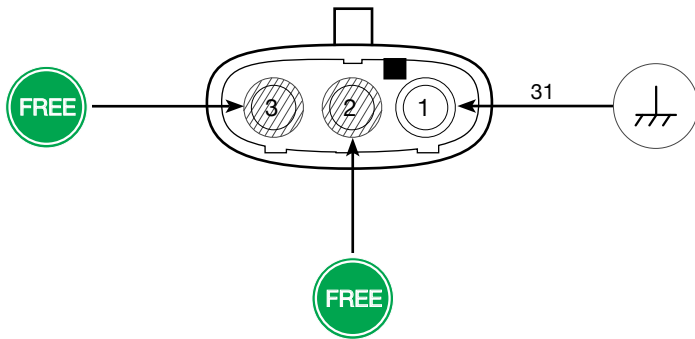

- 1.
- 2.
- 3.
- 4.
- 5.

I_{max}=14A

I_{max}=14A

SuperSeal
4 pin

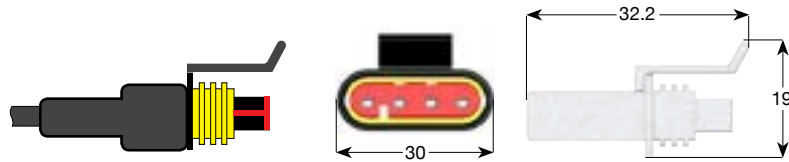

SPARE PART NO.: 15-7002-084

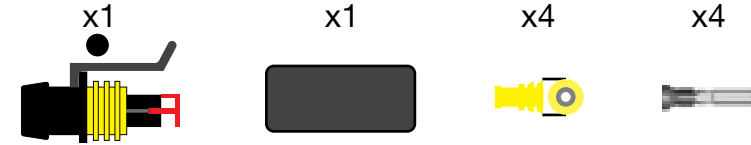

SuperSeal
4 pin

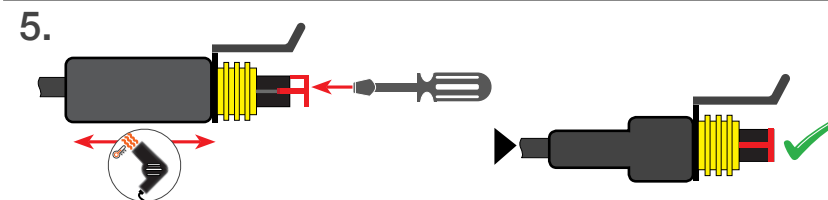
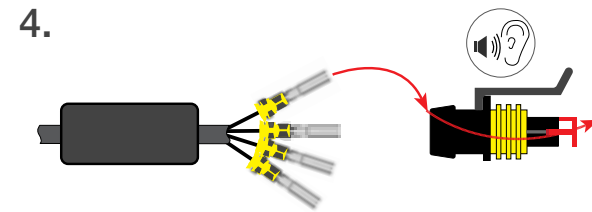
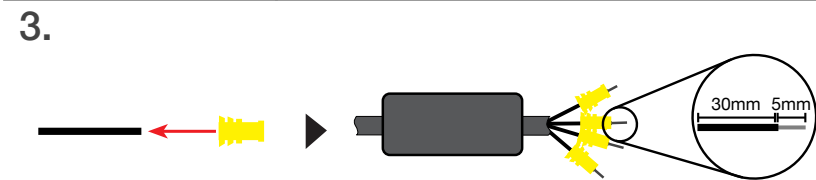
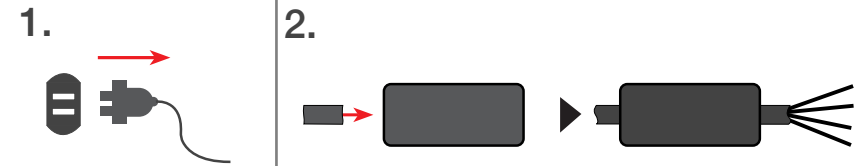
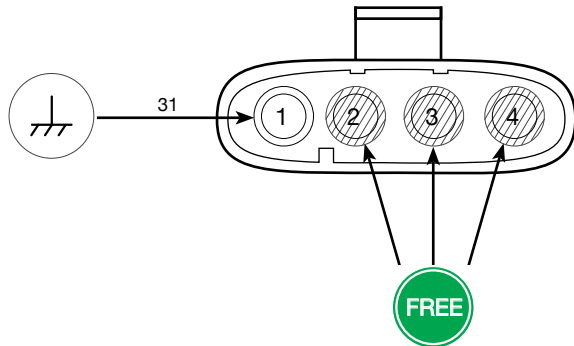

Imax=14A

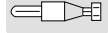

Imax=14A

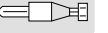

SuperSeal
4 pin

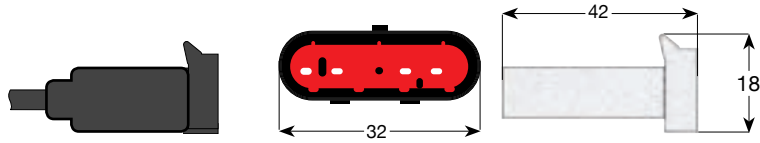

SPARE PART NO.: 15-7002-094

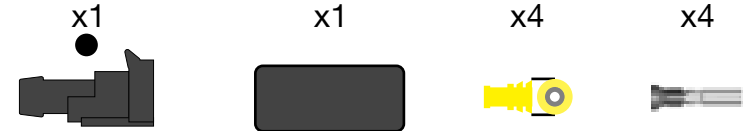

SuperSeal
4 pin

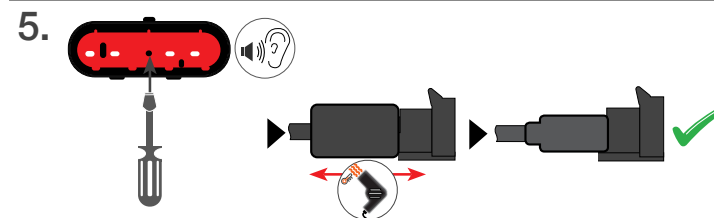
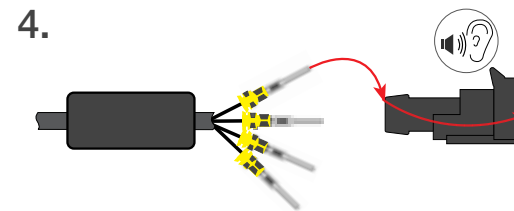
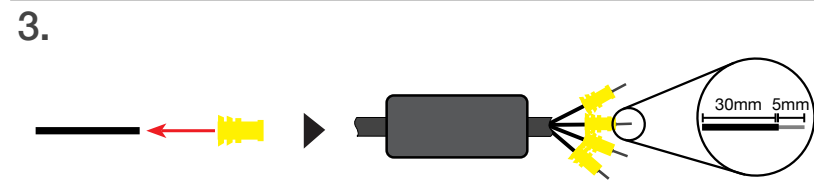
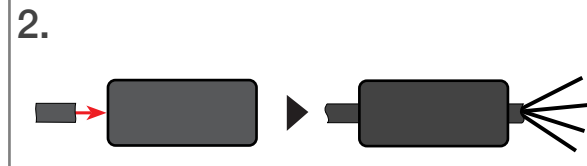
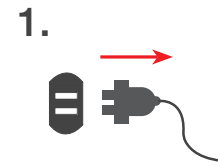
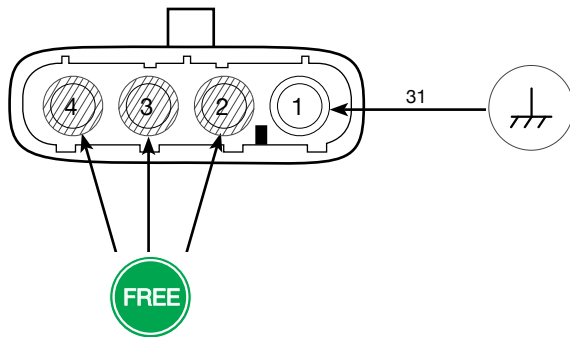

I_{max}=14A



I_{max}=14A



SuperSeal
6 pin

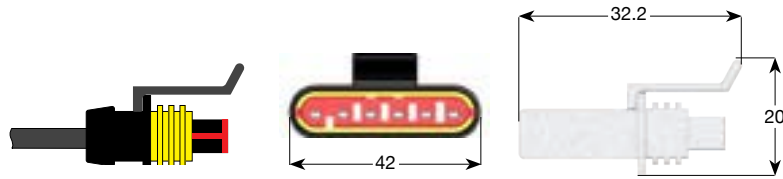

SPARE PART NO.: 15-7002-104

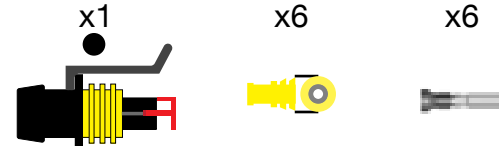

SuperSeal
6 pin

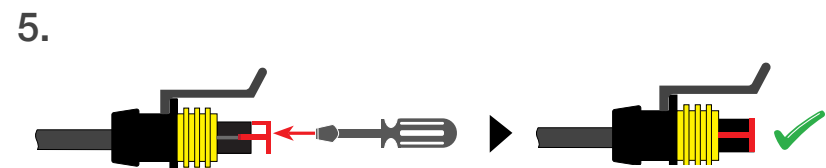
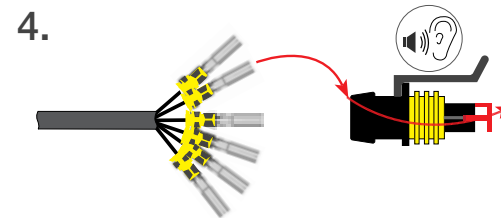
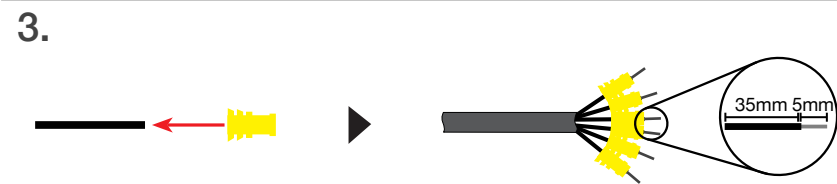
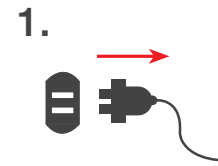
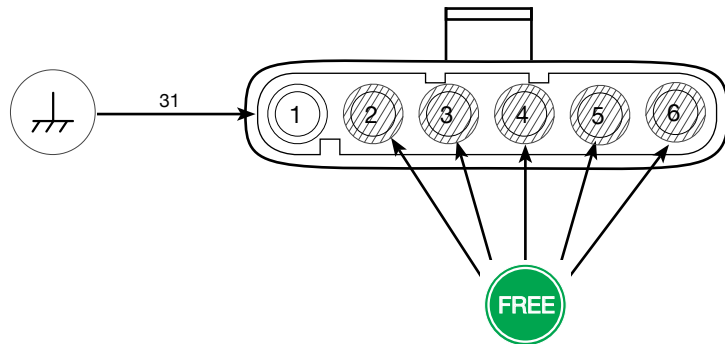

Imax=14A



Imax=14A

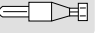

SuperSeal
6 pin

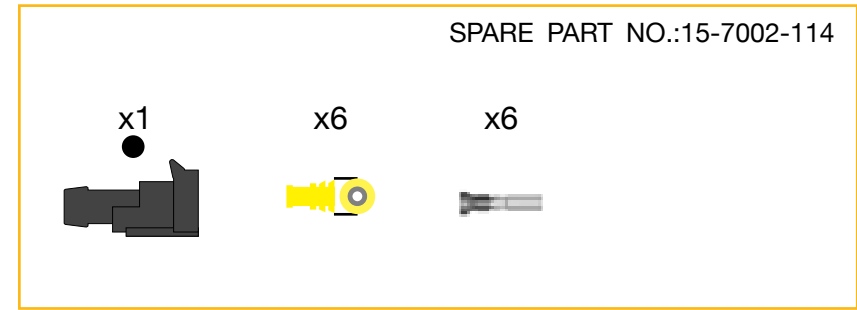
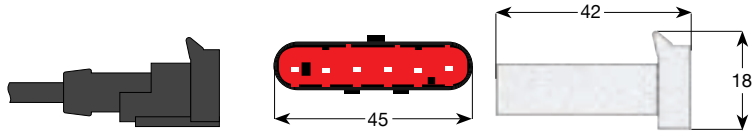

SuperSeal
6 pin

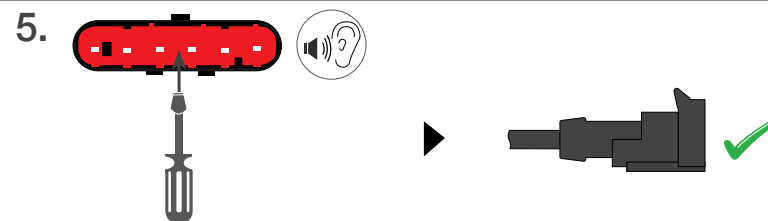
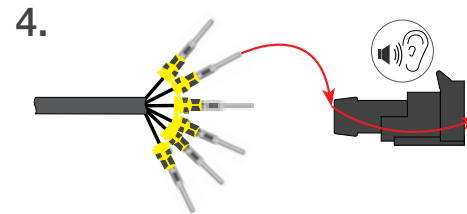
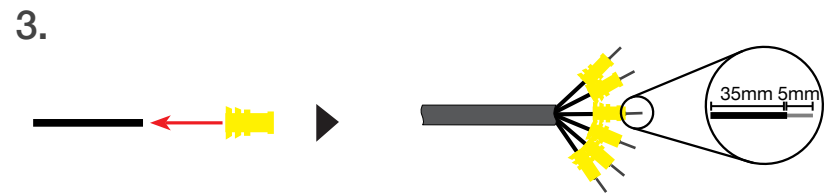
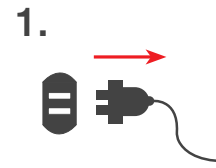
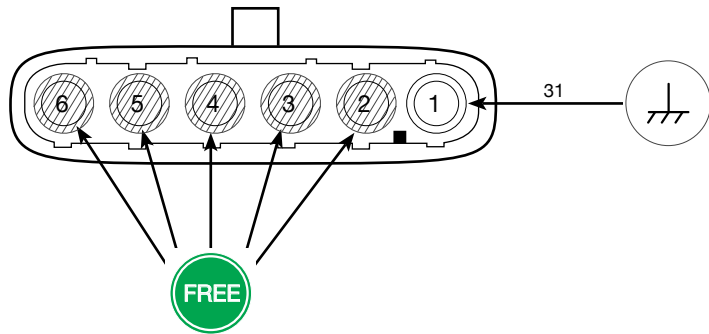

I_{max}=14A



I_{max}=14A

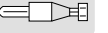

DEUTSCH
2 pin

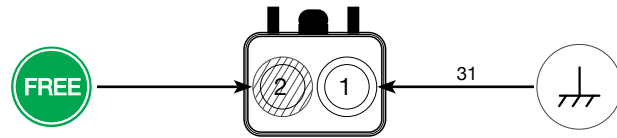
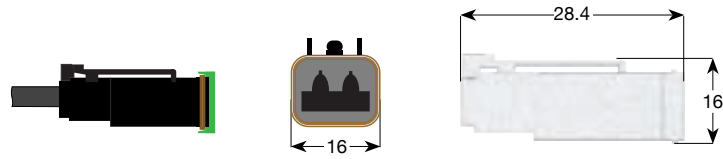

I_{max}=13A

SPARE PART NO.: 15-7002-135

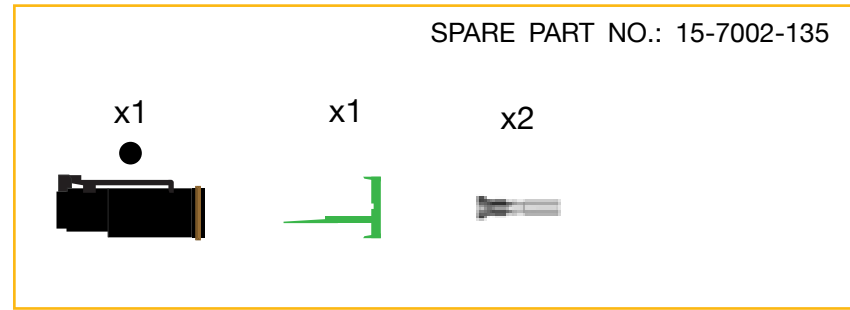

DEUTSCH
2 pin

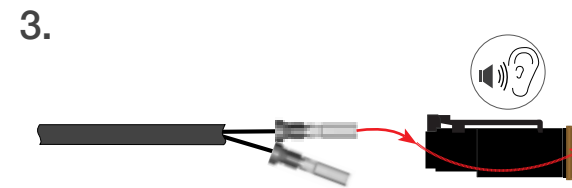
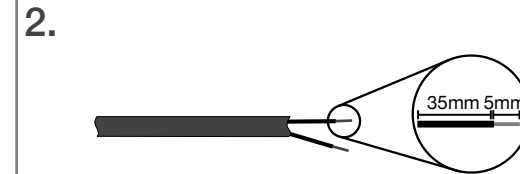
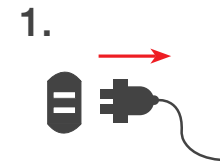

I_{max}=13A

DEUTSCH
2 pin

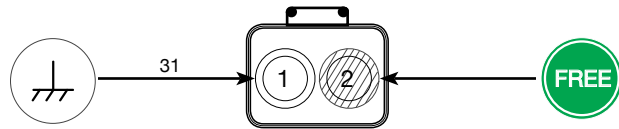
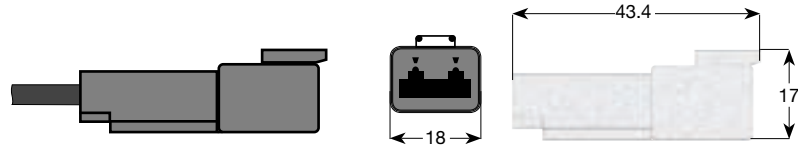

Imax=13A

DEUTSCH
2 pin

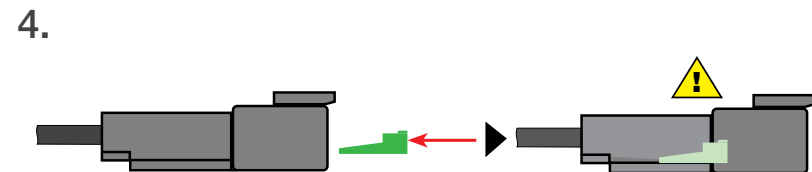
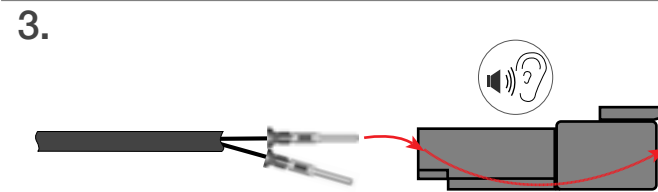
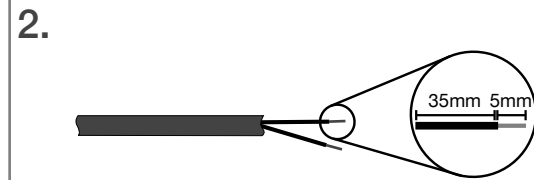
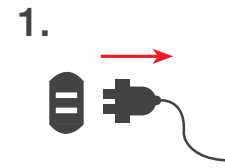
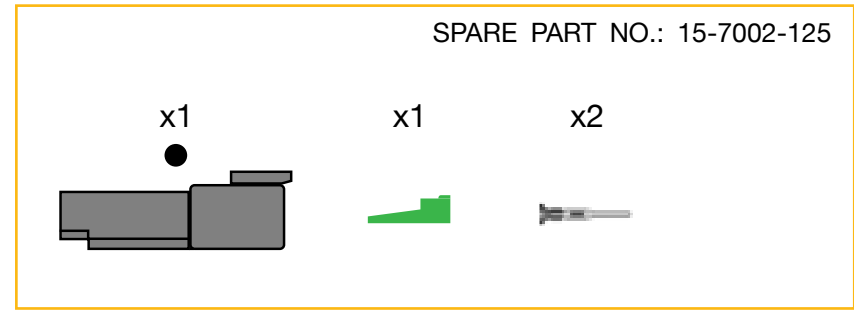

Imax=13A

DEUTSCH
4 pin

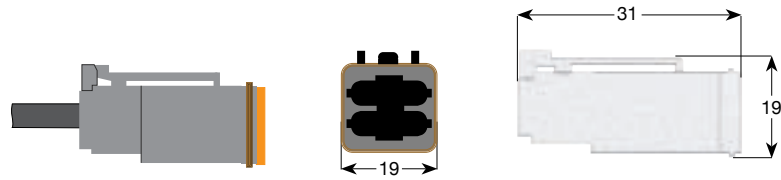

SPARE PART NO.: 15-7002-155

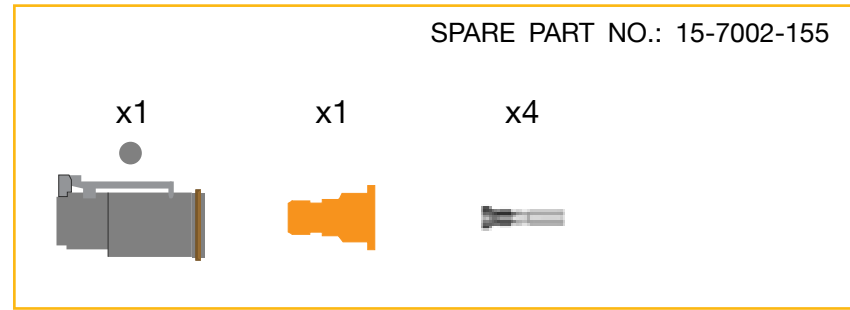

DEUTSCH
4 pin

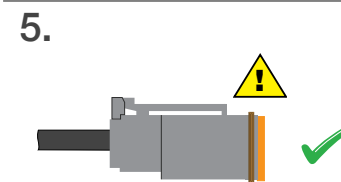
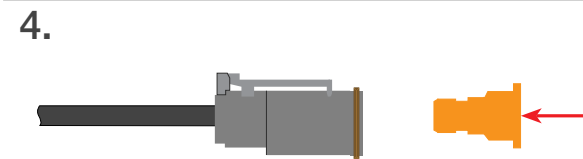
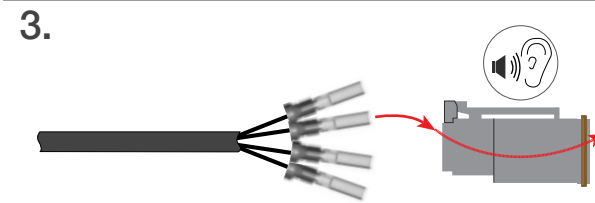
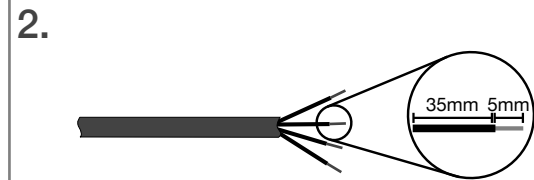
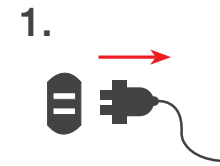
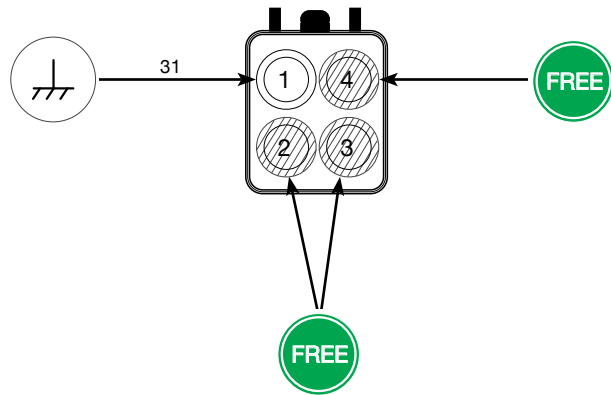
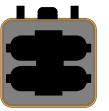

Imax=13A

Imax=13A

DEUTSCH
4 pin

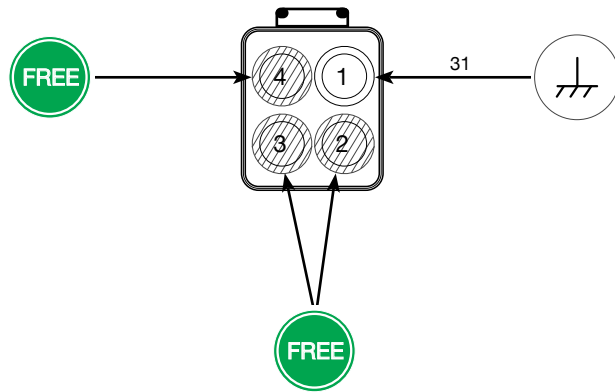
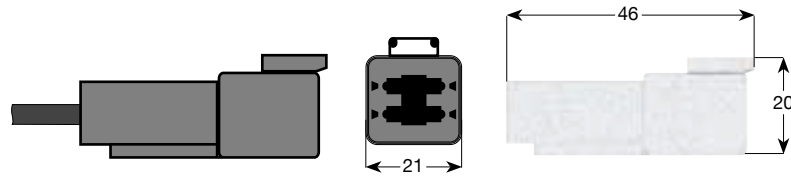

Imax=13A

DEUTSCH
4 pin

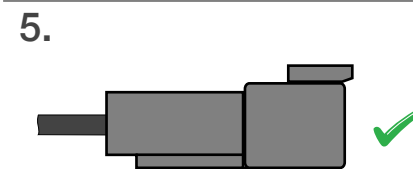
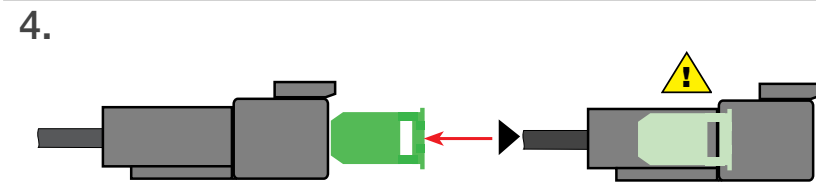
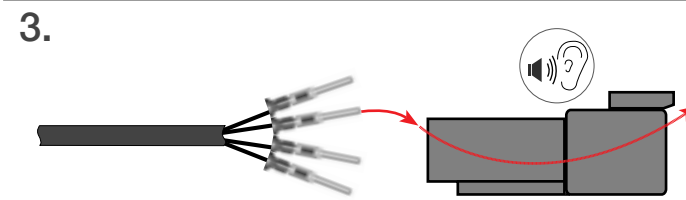
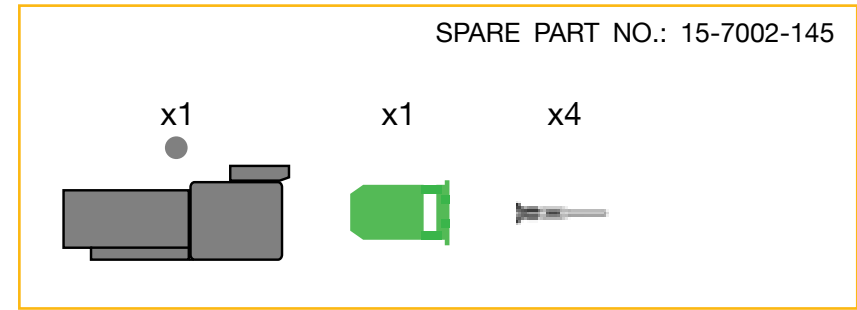

Imax=13A

DEUTSCH
6 pin

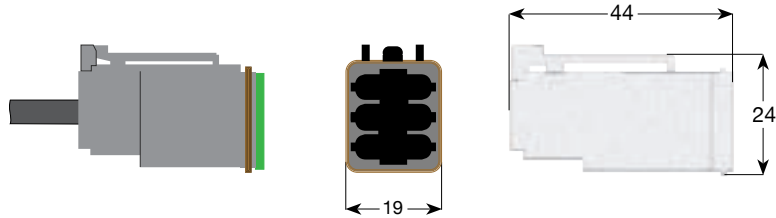

SPARE PART NO.: 15-7002-244

x1

x1

x6



DEUTSCH
6 pin

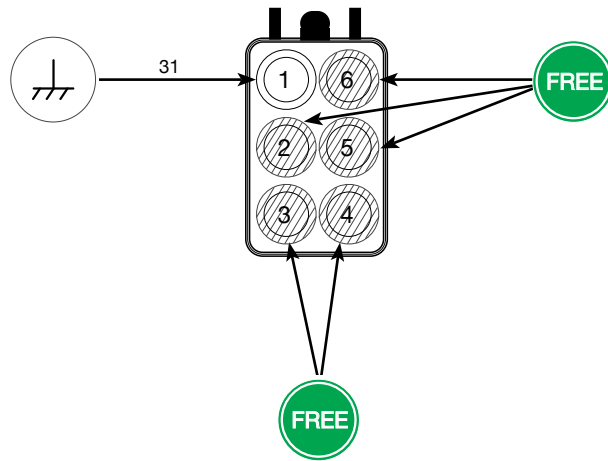

1.

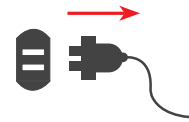

2.

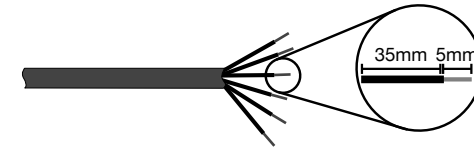

3.

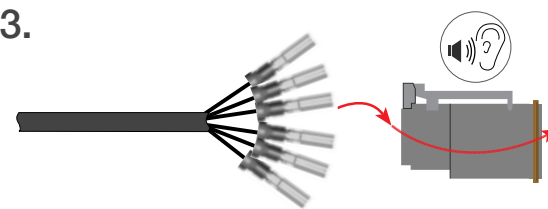

4.



5.

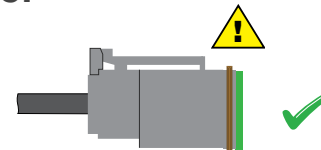

I_{max}=13A



I_{max}=13A

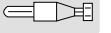

Standard connector 3600 8 pin

Standard connector 3612 12 pin

3600
8 pin

3612
12 pin

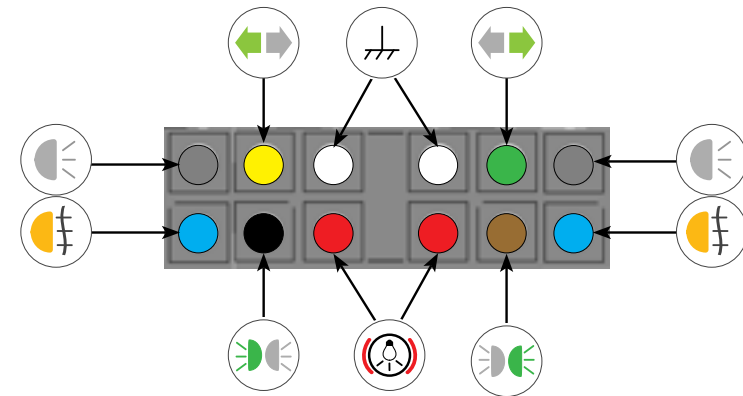
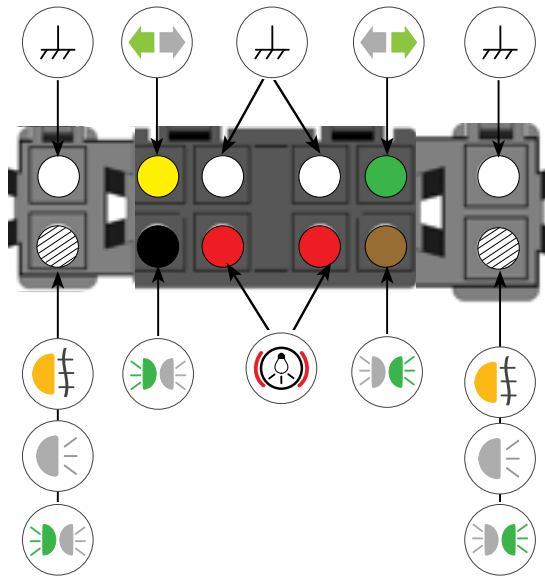
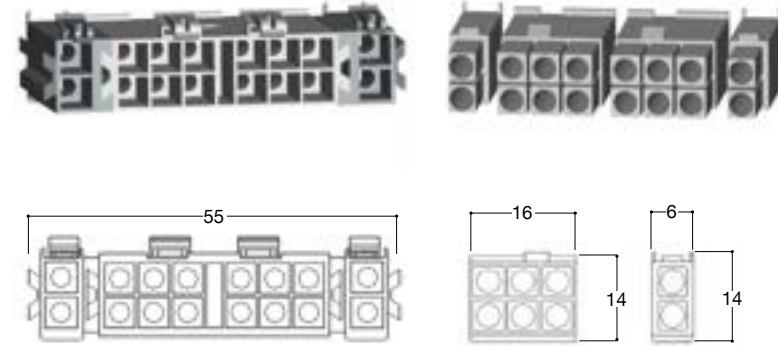
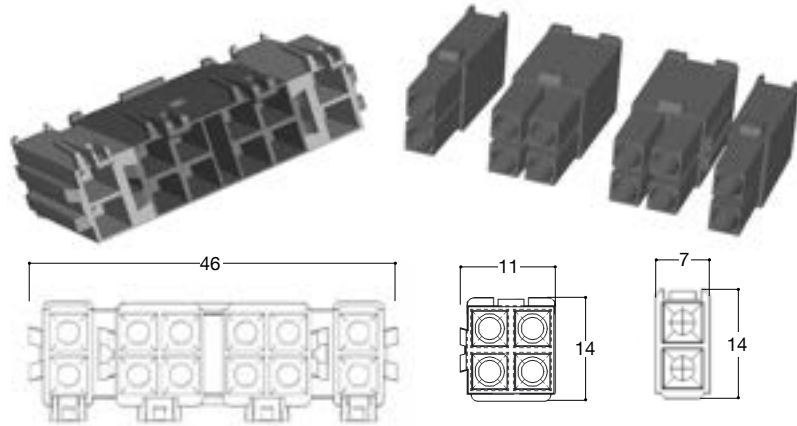

I_{max}=16A

I_{max}=16A

Caravan connector 3650 16 pin

ISO 1185 7 pin, ISO 3731 7 pin

3650
16 pin

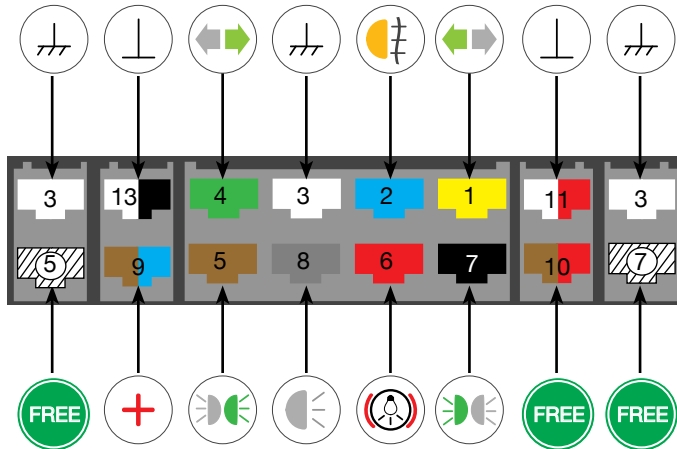
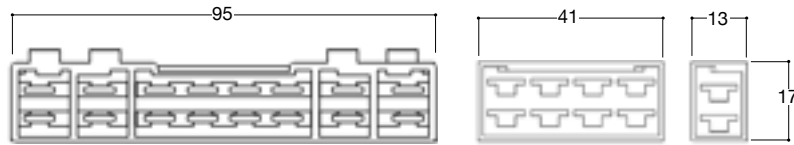

Imax=25A

13-3020-004

13-3128-024



ISO 1185
7 pin

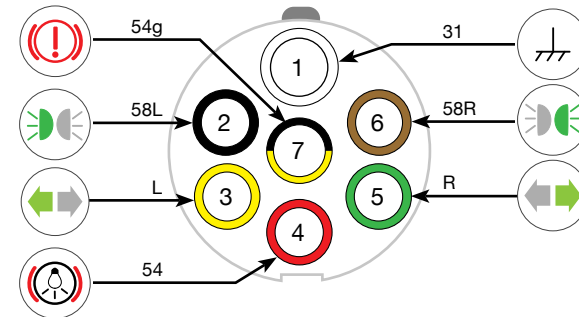

13-3035-004

13-3129-024



ISO 3731
7 pin

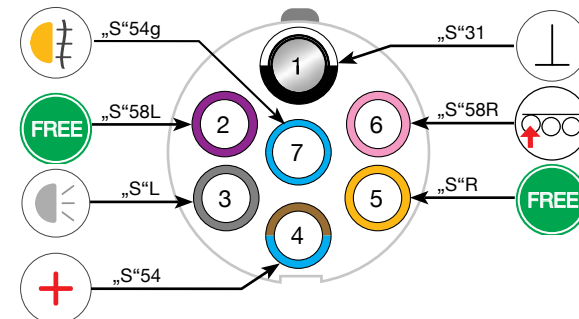
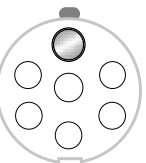

ISO 12098 13 pin

ISO 12098 15 pin

ISO
12098
13 pin

13-3040-004



13-3140-004



13-3070-004



13-3170-004



ISO
12098
15 pin

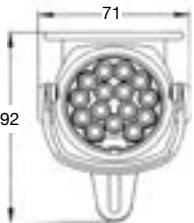
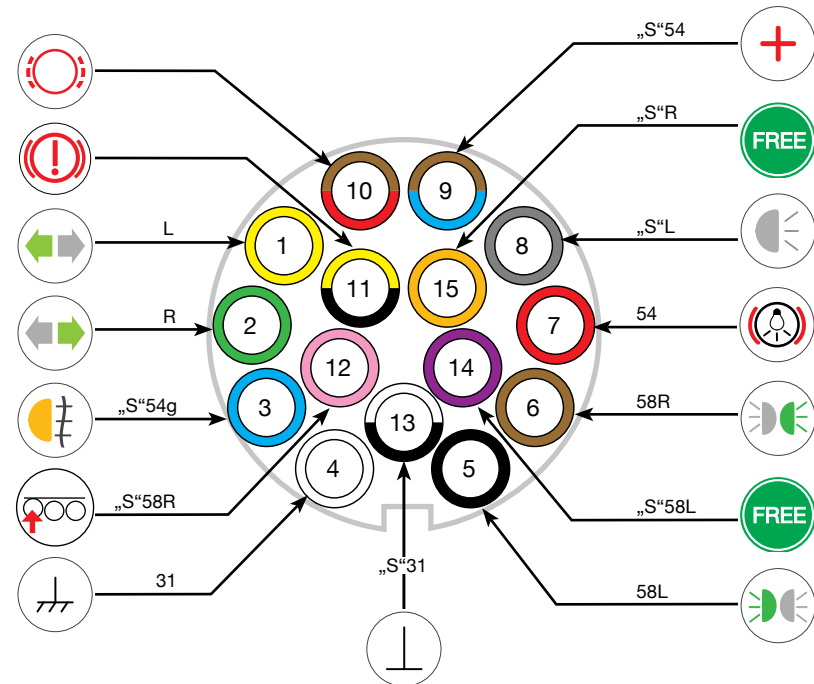
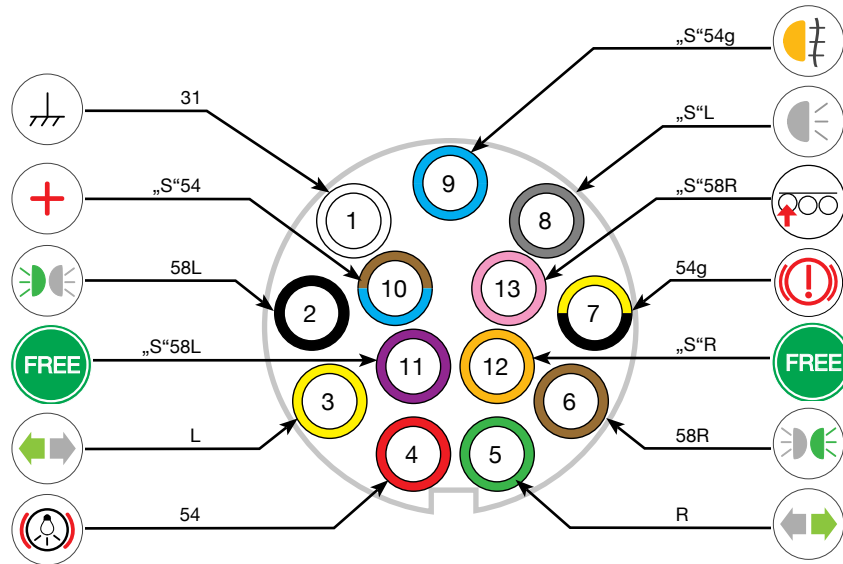
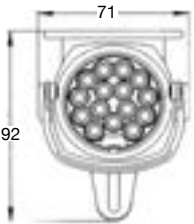

ISO 1724 7 pin

ISO 11446 13 pin, ISO 11446 8 pin

ISO 1724
7 pin

13-3000-054

13-3103-004

13-3137-094

13-3037-004

ISO 11446
13 pin

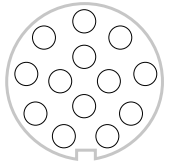
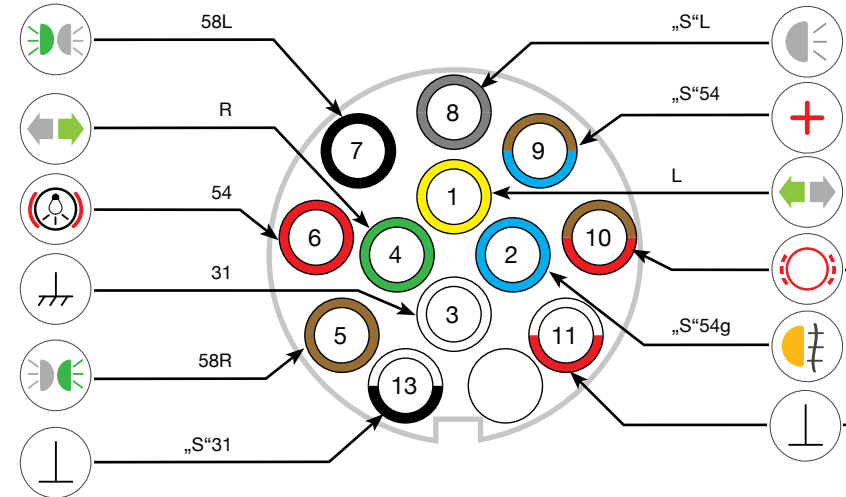
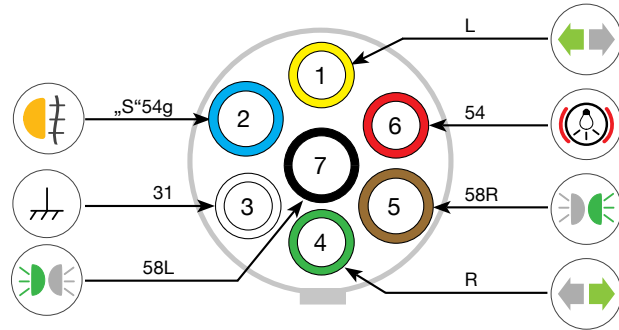

ISO 11446
8 pin

DIN 9680 3 pin

DIN 9680
3 pin

13-3093-504



13-3193-504

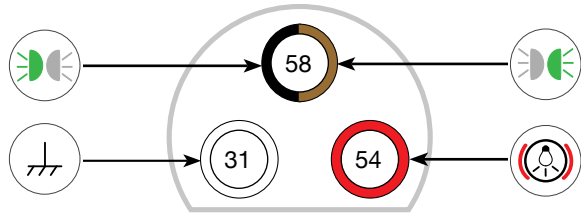

VBG 14 pin

VBG
14 pin

13-3050-001



13-3150-001

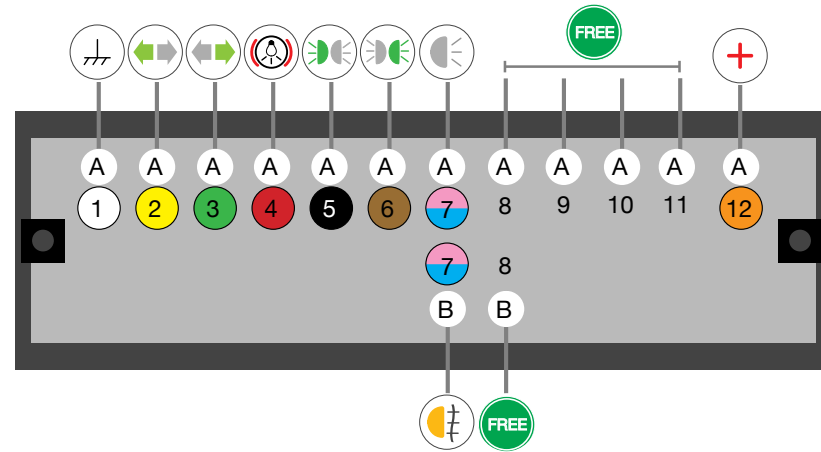

THE ART OF LIGHTS

ASPÖCK SYSTEMS GMBH

Enzing 4 | 4722 Peuerbach | AUSTRIA

Phone: +43 72 76 / 26 70-0

E-Mail: office@aspoeck.com | www.aspoeck.com



Part N.: 10-0350-027
Printing errors, technical changes,
as well as picture changes reserved.
Picture credits: All illustrations and photographs
© Aspöck Systems GmbH 01/2020

MOUNTING SERVICE BOOK CONNECTORS
BOOK SERVICE BOOK

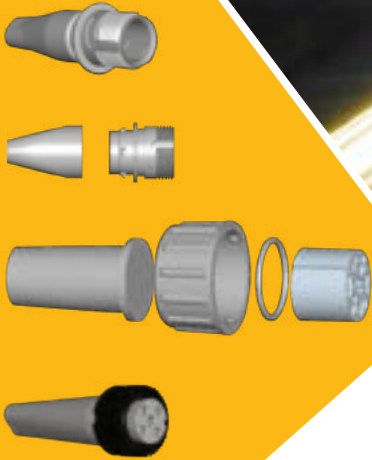

created: LAN checked: TW approved: BM AAW 130.01
Date: 22.02.2016 Date: 01.04.2020 Date: 01.04.2020 Version: 04